

### ADSS-8-15 Dock Shore Step - 8 Steps

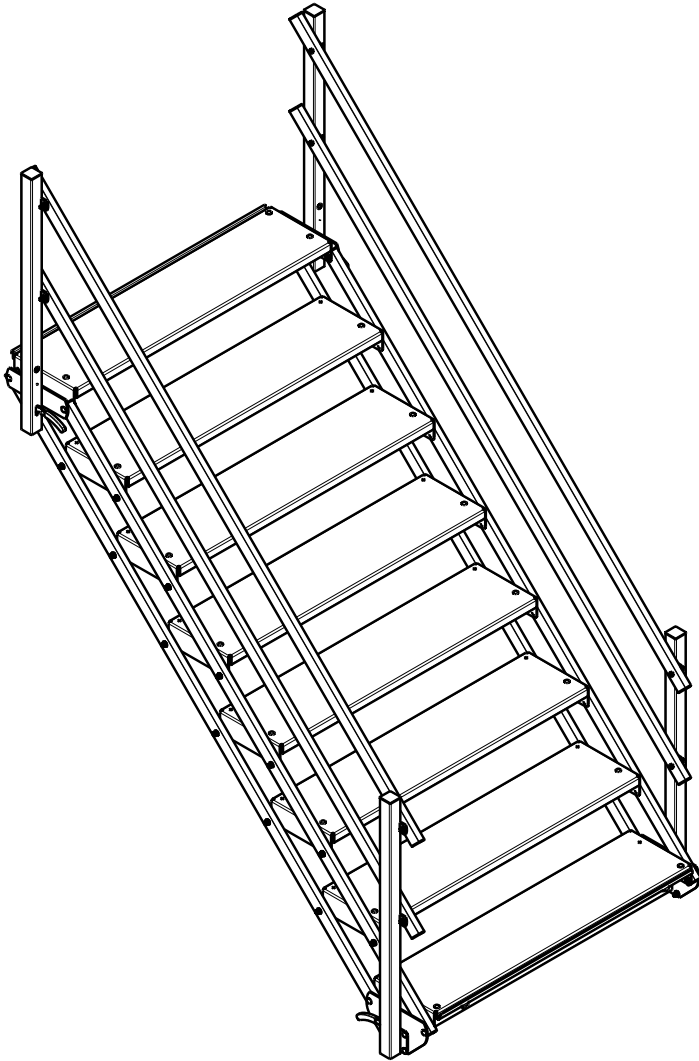

#### Bundles Required

6919015	Leg Bundle Shore Steps
6919215	Shore Step Frame Bundle (8 Step)
6587315	Hand Rail Bundle (8 Step)

#### Tools Required

- 9/16" Wrench/Socket (Assembly)
- Line-up Punch (Assembly)
- Level (Installation)
- Tape Measure (Installation)

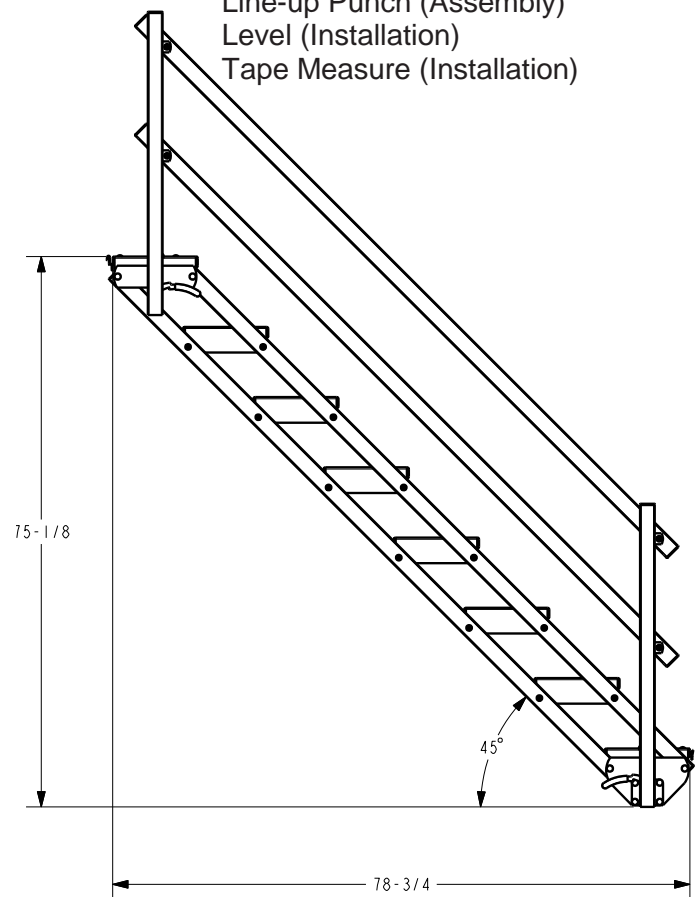

**45° Maximum Recommended  
Installation Angle**

**The assembly and installation of the Aluminum Dock Shore Steps is recommended to be performed by more than one person.**

# Main Frame Assembly

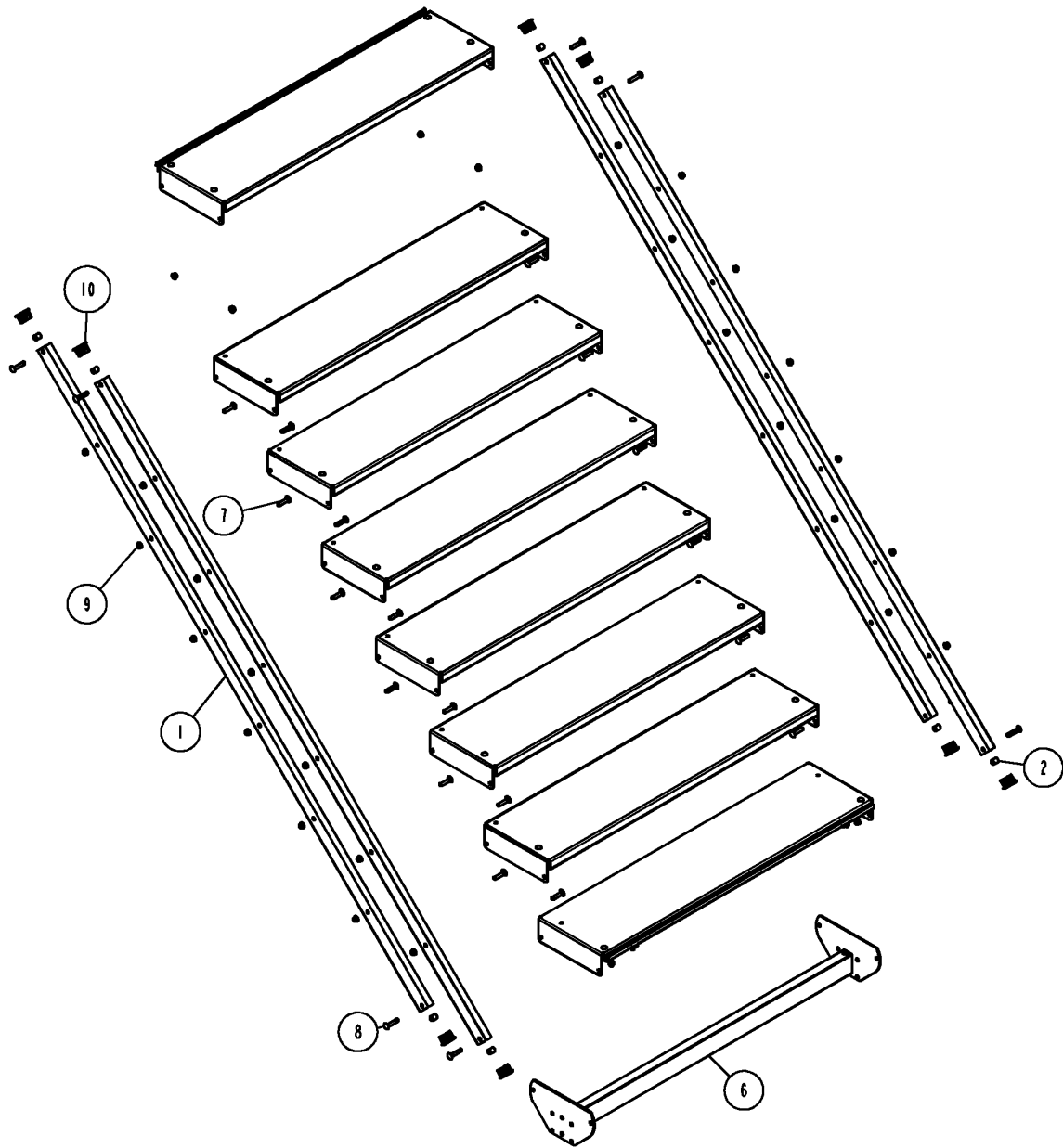

ITEM	PART #	DESCRIPTION	QTY	NOTE
1	65864	SIDE FRAME TUBE 8 STEP	4	
2	66095	BUSHING - DOCK STAIRS SIDEFRAME	8	
3	69105	CONNECTOR STEP ASSEMBLY ALUM SHORE	1	
4	69106	END STEP ASSEMBLY SHORE STEP ALUM	1	
5	69122	DOCK STEP SHORE STEP ALUM	6	
6	69185	WELDMENT CROSSMEMBER SHORESTEP	1	
7	0210276	CARR 3/8-16 X 1 3/4 GR5	24	
8	0210277	CARR 3/8-16 X 2 GR5	8	
9	1440101	HEX LOCKNUT FLANGE 3/8-16 W/T	32	
10	3510214	HAND RAIL END CAP	8	

# 6910515 - CONNECTOR STEP ASSEMBLY ALUM DOCK SHORE STEP

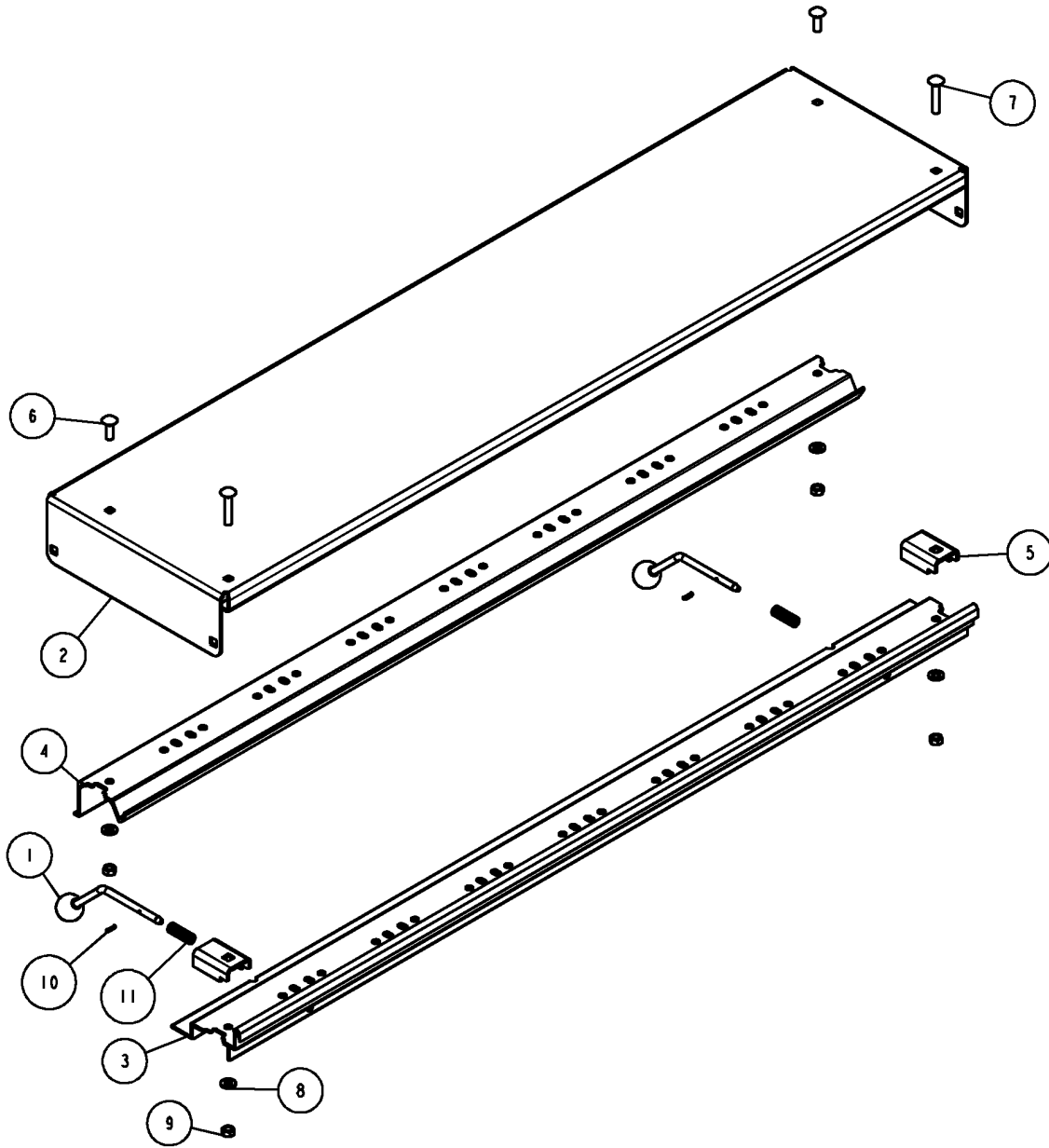

ITEM	PART #	DESCRIPTION	QTY	NOTE
1	65092	LATCH HANDLE	2	
2	69104	SHORE STEP ALUM	1	
3	70976	FEMALE HANGER EXTRUSION	1	
4	70977	DOCK CROSS MEMBER W/LIP 4FT	1	
5	71751	CHANNEL SPACER ALUM DSS	2	
6	0210058	CARR 5/16-18 X 1 GR5 SS	2	
7	0210203	CARR 5/16-18 X 1 3/4 GR5	2	
8	1310085	WASHER USS FLAT 5/16	4	
9	1410079	HEX LOCKNUT 5/16-18 GRA	4	
10	1540407	ROLL PIN - 1/8 X 1/2"	2	
11	2121222	SPRING COMPRESSION STAINLESS DOC	2	

# 6910615 - END STEP ASSEMBLY SHORE STEP ALUM

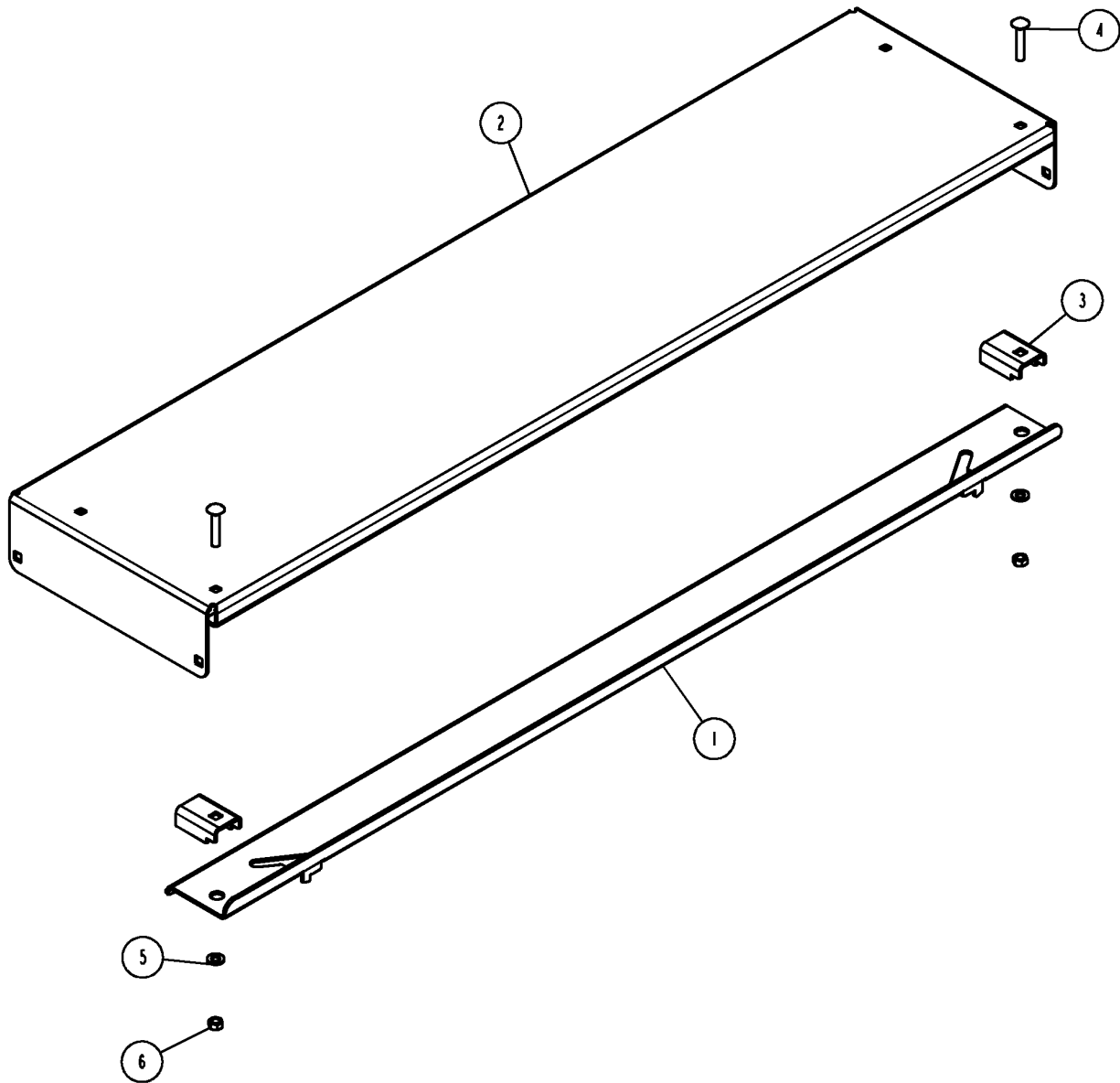

ITEM	PART #	DESCRIPTION	QTY	NOTE
1	65096	DOCK LEG MALE BRACKET 4FT	1	
2	69104	SHORE STEP ALUM	1	
3	71751	CHANNEL SPACER ALUM DSS	2	
4	0210203	CARR 5/16-18 X 1 3/4 GR5	2	
5	1310085	WASHER USS FLAT 5/16	2	
6	1410079	HEX LOCKNUT 5/16-18 GRA	2	

# 6912215 - CENTER STEP ASSY SHORE STEP ALUM

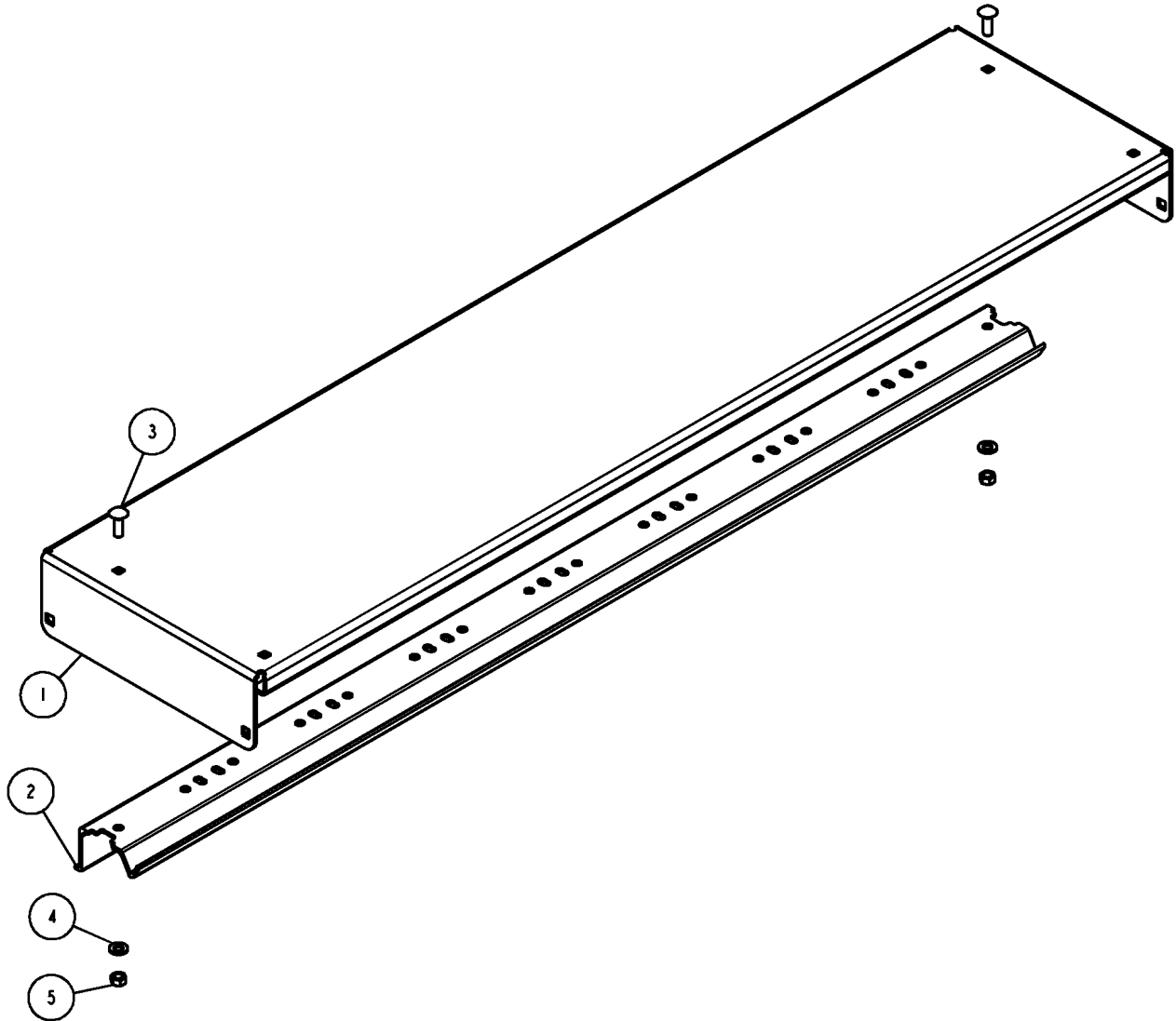

ITEM	PART #	DESCRIPTION	QTY	NOTE
1	69104	SHORE STEP ALUM	1	
2	70977	DOCK CROSS MEMBER W/LIP 4FT	1	
3	0210058	CARR 5/16-18 X 1 GR5 SS	2	
4	1310085	WASHER USS FLAT 5/16	2	
5	1410079	HEX LOCKNUT 5/16-18 GRA	2	

# Leg Assemblies & Handrails

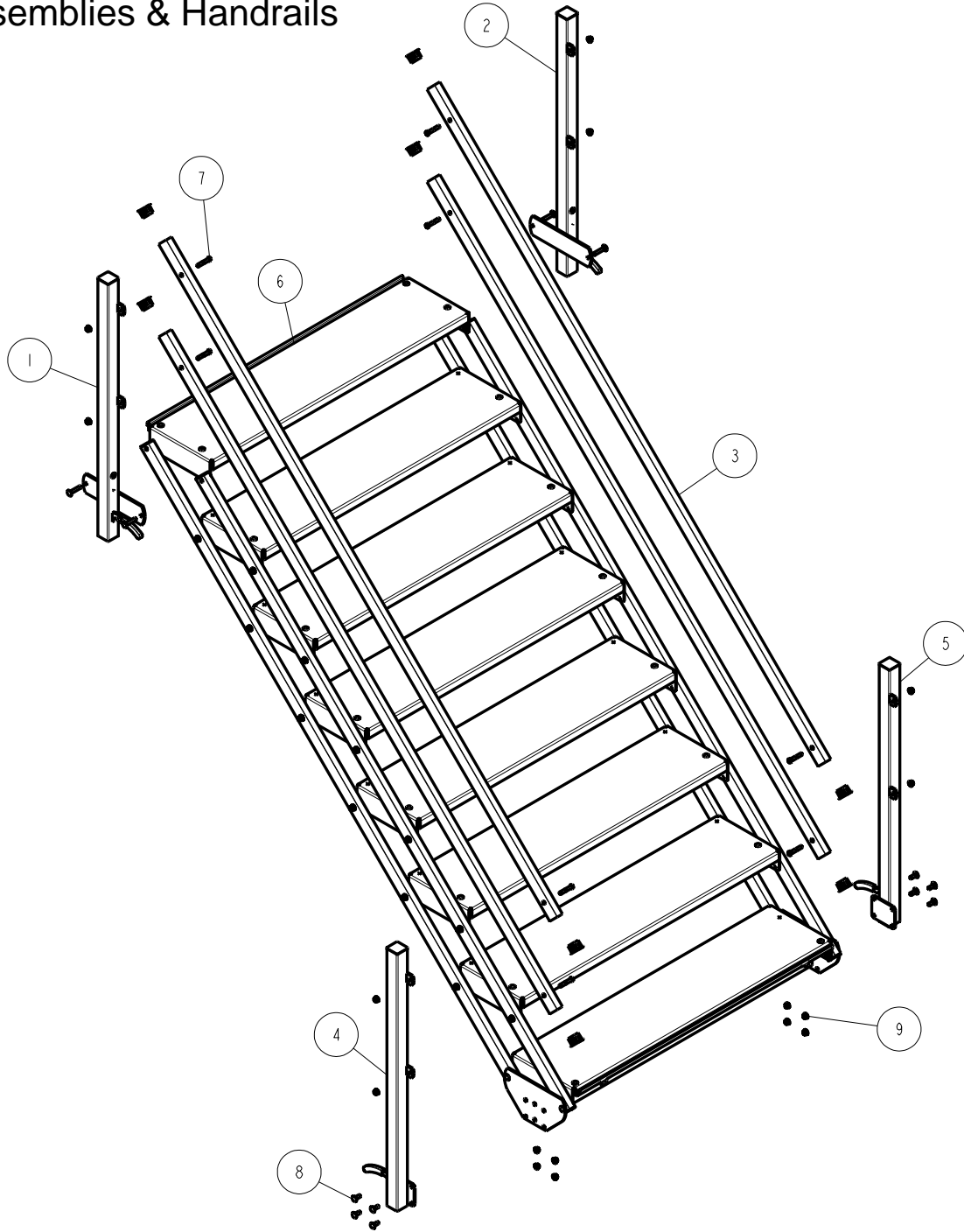

ITEM	PART #	DESCRIPTION	QTY	NOTE
1	65856	LEFT LEG ASSEMBLY - SHORE STEPS	1	
2	65857	RIGHT LEG ASSEMBLY - SHORE STEPS	1	
3	65867	HAND RAIL ASSEMBLY(8 STEP)	4	
4	69188	ASSEMBLY LEFT LEG SHORESTEP BOTTOM	1	
5	69189	ASSEMBLY RIGHT LEG SHORESTEP BOTTOM	1	
6	69192	BUNDLE FRAME MAIN 8 SHORESTEP	1	
7	0110048	HH 3/8-16 X 2 CS GR5	8	
8	0210102	CARR 3/8-16 X 1 GR5	8	
9	1440101	HEX LOCKNUT FLANGE 3/8-16 W/T	16	

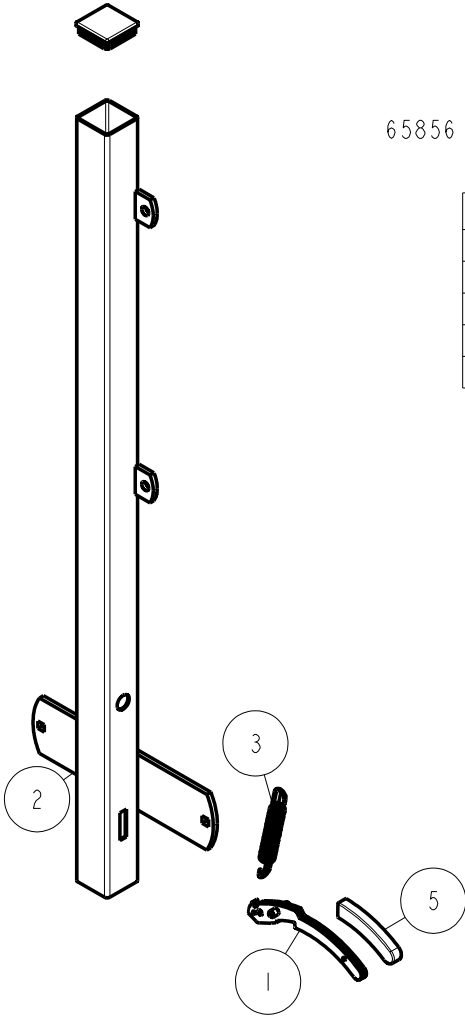

65856

ITEM	PART #	DESCRIPTION	QTY	NOTE
1	65135	CAM LEVER ASSY	1	
2	65890	SHORE STEP LEG WMENT LEFT	1	
3	2121223	SPRING DOCK CAM LEVER	1	
4	3510394	CAP BLK PLACTIC 2IN .08 TO 10G	1	
5	3510570	LATCH HANDLE PLASTIC COVER - DOC	1	

65857

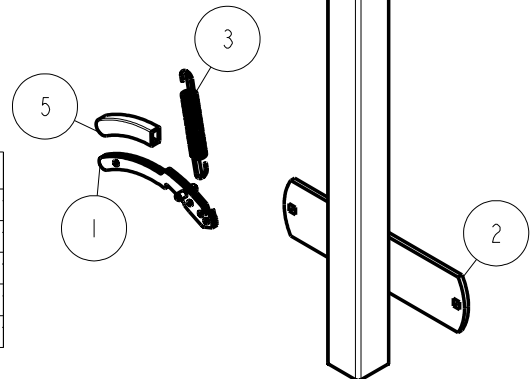

ITEM	PART #	DESCRIPTION	QTY	NOTE
1	65135	CAM LEVER ASSY	1	
2	65891	SHORE STEP LEG WMENT RIGHT	1	
3	2121223	SPRING DOCK CAM LEVER	1	
4	3510394	CAP BLK PLACTIC 2IN .08 TO 10G	1	
5	3510570	LATCH HANDLE PLASTIC COVER - DOC	1	

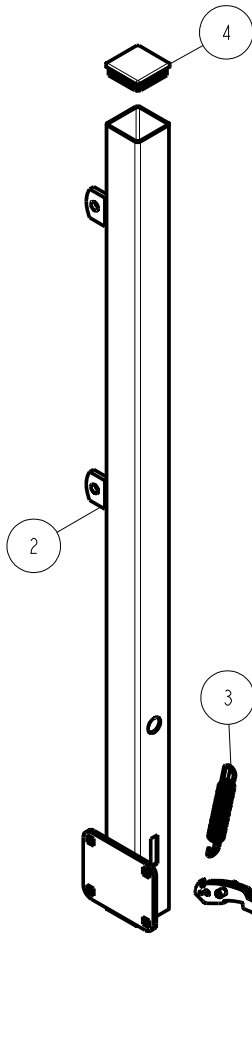

69188

ITEM	PART #	DESCRIPTION	QTY	NOTE
1	65135	CAM LEVER ASSY	1	
2	69186	WELDMENT LEFT LEG SHORESTEP BOTTOM	1	
3	2121223	SPRING DOCK CAM LEVER	1	
4	3510394	CAP BLK PLACTIC 2IN .08 TO 10G	1	
5	3510570	LATCH HANDLE PLASTIC COVER - DOC	1	

69189

ITEM	PART #	DESCRIPTION	QTY	NOTE
1	65135	CAM LEVER ASSY	1	
2	69187	WELDMENT RIGHT LEG SHORESTEP BOTTOM	1	
3	2121223	SPRING DOCK CAM LEVER	1	
4	3510394	CAP BLK PLACTIC 2IN .08 TO 10G	1	
5	3510570	LATCH HANDLE PLASTIC COVER - DOC	1	

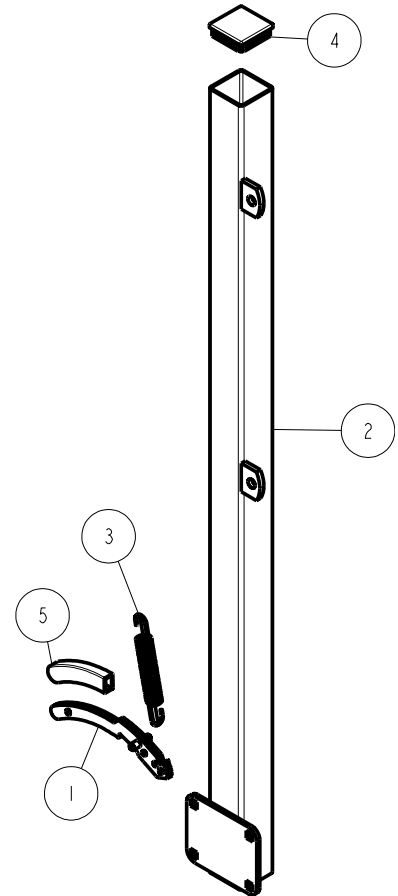



## ASSEMBLY INSTRUCTIONS

1. Cut the banding on the bundles and sort the parts and hardware by size.
2. Identify the top of the steps by locating the end with the two latch pins. Once located, position the steps so that they are right side up.
3. Loosen the bolts that hold the steps to the side rails slightly so that they can be rotated.

4. Identify the bottom leg frames. Position the bottom legframe weldments on the outside of the crossmember weldments. Insert the bolts through the holes in the plates of the leg frame weldment, crossmember weldment. With the bolts are in place secure on the inside of the crossmember weldment with a 3/8" hex flange lock nut. With the flange lock nut tightened, place an acorn nut on the exposed threads of bolts. Repeat on other bolts. Position as shown with leg cam lever pointing towards the step assembly.

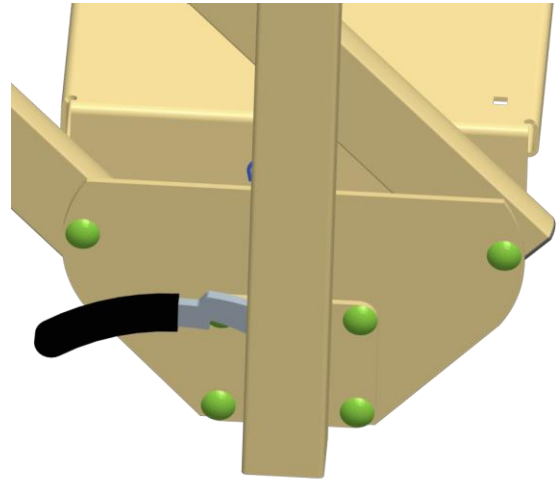

5. Note that the bolts that hold the top step to the side rails are shipped with the nuts on the outside. These bolts will have to be removed and repositioned the opposite direction when the leg weldments are installed. Also note that there is a spacer bushing located inside the side rail to keep the tube from collapsing when tightening. Caution should be used when removing the bolts so that this spacer is not lost or positioned improperly.

**Tip:** When mounting the upper leg assemblies, remove only one bolt at a time. Insert it into the corresponding hole on the leg assembly, then thru the side rail assembly with bushing and cap and then thru the step assembly. Repeat this process by removing the bolt swing the leg assembly into position and insert from the outside in.

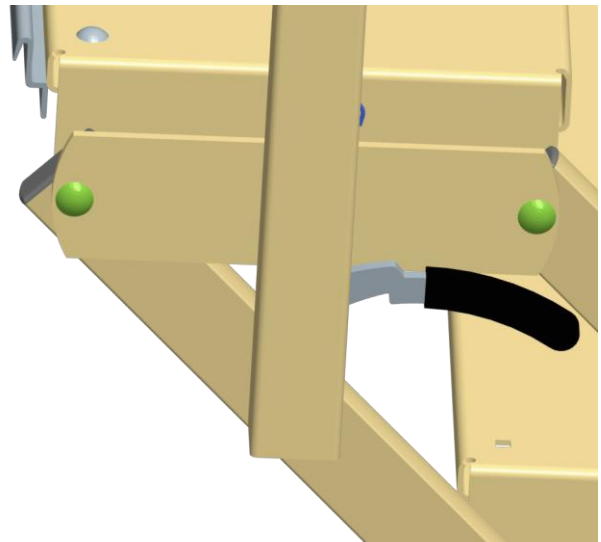

7. Identify the top right and left leg frame weldments. Position the leg frames so that the leg cam levers are pointing towards the step assembly. (See drawings on page 4.) Remove the bolts using the procedure in Step 5. Secure the right and left leg frames to the side rails with the bolts just removed. Secure with 3/8" flange lock nuts. With the flange lock nut tightened, place an acorn nut on the exposed threads of bolts.

## Handrail Assembly Instructions

Locate the handrails. Note that the holes in the handrails are at different distances from the ends of the rail. Position the handrails so that the end with the hole 2-1/2" from the end is attached to the bottom leg frame weldments. Attach the rails to the leg frames by placing a 3/8" x 1-3/4" bolt through the rail, then insert the bolt through the hole provided in the leg frame. Secure with a 3/8" acorn lock nut. Repeat this process on the other end of rail and on other rails.

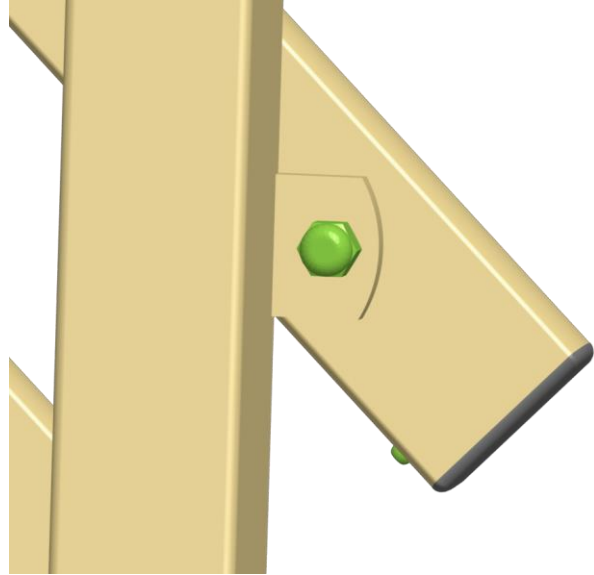

## Final Installation Instructions

Note that the extension legs are not provided with the dock steps because every application will require its own length of legs. Legs are available in the following lengths: 10", 17", 31", 49", & 61". Purchase the leg length that best fits your application.

Once the steps are in their permanent location, tighten all nuts and bolts loosened during assembly. Assembly is complete.

## Safety Instructions

<b>⚠ WARNING</b>	
<b>PINCH POINT</b> Keep hands and feet clear of side rails during installation and adjustment.	
<b>IMPORTANT:</b> Read Owner's Manual carefully before installing steps. <small>4850371</small>	

## Safety Tips for Lifting and Carrying

- Make sure you have help installing this product. The weight of this unit is 142 lbs.
- Make sure your footing is solid.
- Get close to the load.
- Keep your back straight.
- Center your body over your feet.
- Lift with your legs.
- Move your feet to turn - Don't twist.
- Use mechanical assistance if it's available.
- Clear a pathway for carrying.
- Communicate with lifting partners when lifting/carrying.
- Take small steps when carrying.
- Signal lifting partners when ready to lift and set down.
- Keep hands clear when folding and unfolding rail bundle.
- Steps may slippery when wet - Use handrails.