

# SS#230A

## Attaching Bracket for SSAA Spindles

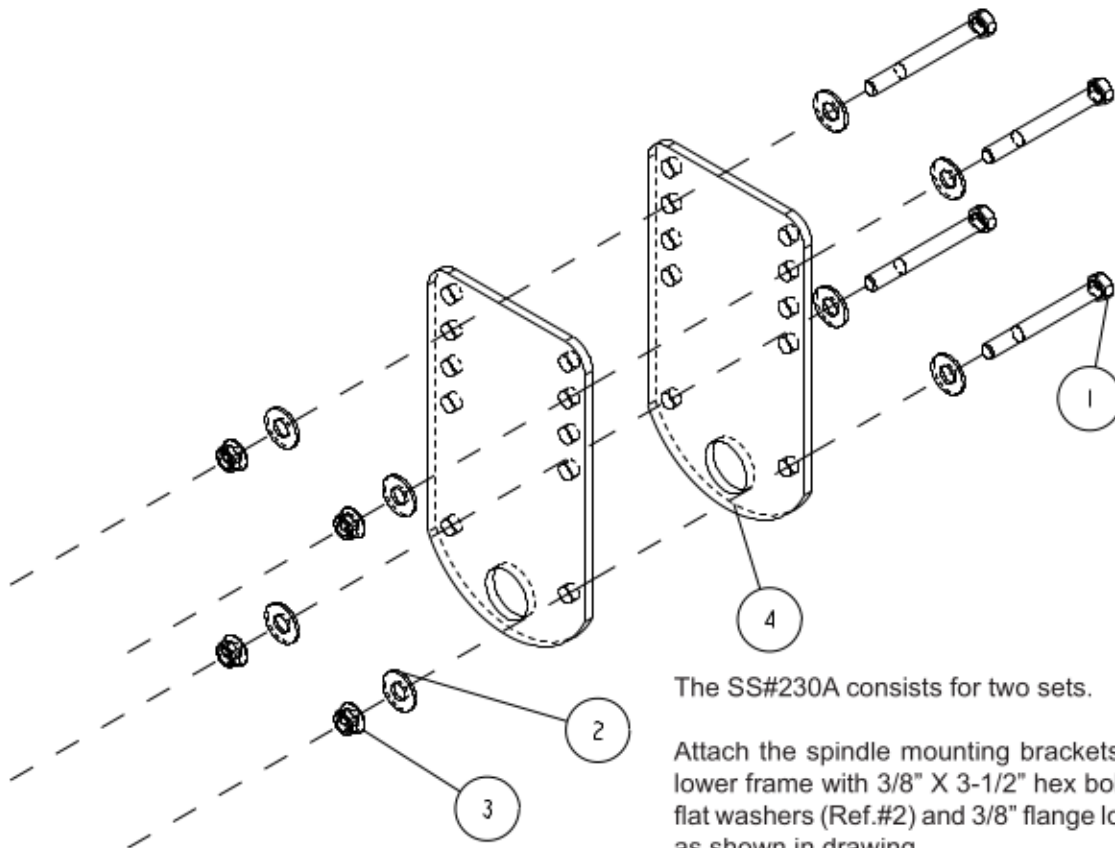

The SS#230A consists for two sets.

Attach the spindle mounting brackets (Ref.#4) to the lower frame with 3/8" X 3-1/2" hex bolts (Ref.#1), 3/8" flat washers (Ref.#2) and 3/8" flange lock nuts (Ref.#3) as shown in drawing.

Repeat on the other end of hoist.

Note: When attaching the spindle mounting brackets, measure approximately 36" from the guide post opposite the winch end. Measure 48" from the guide post on lower frame on models 6,000 lbs. and above.

### BILL OF MATERIALS

ITEM	PART #	DESCRIPTION	QTY
1	0110050	HH 3/8-16 X 3 1/2 CS GR5	4
2	1340095	WASHER USS FLAT 3/8	8
3	1440101	HEX LOCKNUT FLANGE 3/8-16 W/T&T	4
4	A153	SPINDLE MOUNTING BRKT - ALUM	2