



411 West Congress St., Maple Lake, MN 55358 Toll Free 877-466-8837 [www.wavearmor.net](http://www.wavearmor.net)

## Wave Dock Instructions

Depending on the options you purchased, you may not have all the parts shown below. Before beginning assembly, be sure to familiarize yourself with the parts.

Part	Name
A	Dock Section
B	Corner Gusset
C	24" H-Beam
D	50" H-Beam
E	Post Attachment
F	Pipe Adapter
G	Vertical Bumper
H	Horizontal Bumper
I	Dock Ramp
J	Wave Port
K	Bow Stop
L	Tie-Down Cleat - Small
M	Flip up Cleat - Large
N	Entrance Slide
O	Port Front and Dock Hinge
P	Side Hinge
Q	Universal Hinge
R	Linkage Arm
S	6' Entrance Deck
T	16" C-Clamp
U	24" C-Clamp
V	16" H-Beam
W	Post Attachment ,7" Port Side
X	Entrance Plug
Y	Entrance Slide
Z	Top Roller Plug
1	¼ x 1 ½ Flat Head Machine Screw
2	3/8 x 1 ½ Bolt
3	3/8 Washer
4	3/8 x ¾" Bolt
5	½" Shoulder Bolt
6	Fender Washer for Shoulder Bolt

## Tools Needed

9/16" socket and ratchet with extension  
Phillips screwdriver if installing bow stop on Wave Port  
Dead Blow Mallet, or a maul and block of wood

Instructions - 70781



A – Dock Section

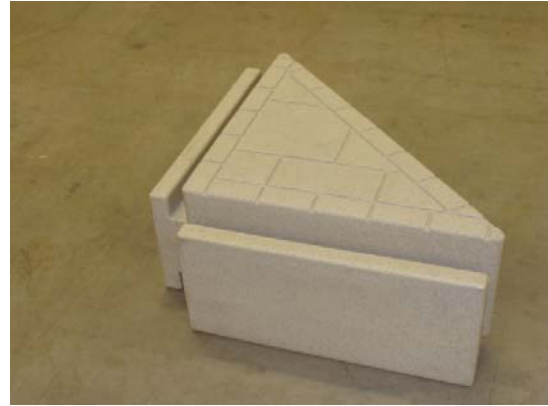

B - Corner Gusset



C – 24” H Beam

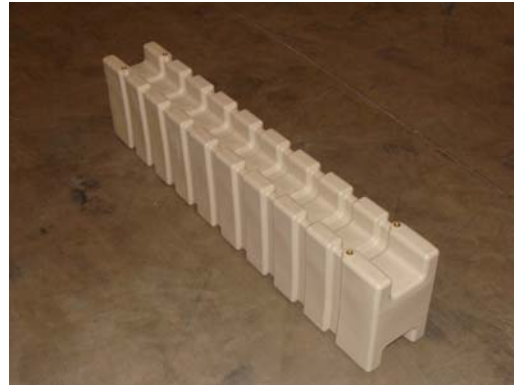

D – 50” H Beam



E - Post Attachment Port  
Front & Wave Dock



F - Post Attachment  
Insert/Adapter



G - Vertical Bumper



H - Horizontal Bumper 24"



J - Wave Port - 6 Foot



K- Bow Stop



L - Fixed Cleat - Small



M - Flip-Up Cleat



N - Entrance Slide



O - Port Front and Dock Hinge



P - Side Hinge- Port



Q - Universal Dock Hinge



R - Linkage Arm 24"



S - 6 Ft Linkage/Entrance Deck



T – 16” C Clamp



U – 24” C Clamp



V – 16” H Beam



W - Side Post Attachment – Port Only



1 – ¼ x 1 ½ flat head machine screw



2 – 3/8 x 1 ½ bolt  
3 – 3/8” washer



4 – 3/8 x ¾ Bolt  
3 – 3/8” washer



5 – ½” Shoulder Bolt  
6 – ½” Fender washer

## General Recommendations

1. Work with two or more people on calm water.
2. Unpack all the materials and familiarize yourself with the parts.
3. Begin working on the sections of the dock that eventually will be farthest from the shoreline first and slide them into the water as you add new sections.
4. The assembly options you follow below will depend on your specific dock layout plan. In general, assemble two dock sections together, add any accessories, and then add the next dock section(s).
5. Some configurations will require assembly of dock sections in a specific order, especially when working with corner gussets. See **Sample Layout Orders of Assembly** at the end of these instructions for recommendations.
6. Use liquid dish soap on H-beams, channels, and other parts to help ease insertion.

## Assemble Dock Sections

### *Assemble Dock Sections End-to-End*

1. Move two dock sections (Part A) into the water, short end to short end.
2. Holding the ends of the dock sections together, slide a 24" H-beam (Part C) into the channels of the two sections. Make sure the end of the H-beam with four threaded inserts is to the outside of the dock sections (see pictures).
3. Gently pound the H-beam into the dock section channels using a mallet or hammer and wood block until the outermost threaded inserts of the H-beam are lined up with the holes in the decking of the dock sections. Do not drive the H-Beam in too far or it will need to be pounded back out so the holes align.
4. Insert 2 bolts and washers (Parts 2 & 3) through the decking into the threaded inserts of the H-beam and tighten.
5. Repeat with another H-beam on the other side of the dock section, making sure the end of the H-beam with four threaded inserts is to the outside of the dock sections.



H-Beam ready to slide into  
Dock Section channels



H-Beam Sliding into  
Channels of Dock Sections



H-Beam Bolted into  
Dock Sections

### ***Assemble Dock Sections in an L-Shape***

1. Move two dock sections (Part A) into the water, short end to long side (see diagram).
2. Slide a 24" H-beam (Part C) into the channel of the long-sided dock section from the end opposite the short-sided section. Make sure the end of the H-beam with four threaded inserts is to the far side of the dock section. Gently pound the H-beam into the channel using a mallet or hammer and wood block.
3. When the H-beam is close to the short-sided dock section, begin pounding into channels of both dock sections until the outermost threaded inserts of the H-beam are lined up with the hole in the decking of the short-sided dock section .
4. Note that this H-beam will be attached with only one bolt and washer. Insert 1 bolt and washer (Parts 2 & 3) through the decking of the short-sided dock section into the threaded inserts of the H-beam and tighten.
5. Slide another 24" H-beam (Part C) into the channels of the dock sections on the other side, making sure the end of the H-beam with four threaded inserts is to the outside of the dock sections.
6. Insert 2 bolts and washers (Parts 2 & 3) through the decking into the threaded inserts of the H-beam and tighten.



L-Shape with H-Beams sliding  
into position. H-Beams will not  
be visible when fully positioned



Top view showing alignment of  
holes and H-Beams sliding into  
position

### ***Assemble 4 Dock Sections on Long and Short Sides***

1. Move two dock sections (Part A) into the water, long sides together.
2. Holding the dock sections together, slide a 50” H-beam (Part D) into the channels of the two sections.
3. Gently pound the H-beam into the dock section channels using a mallet or hammer and wood block until the threaded inserts toward the “outside” of the H-beam are lined up with the “outside” holes in the decking of the dock sections (see diagram).

Note that the H-beam will be attached with only two bolts.

4. Insert 2 bolts and washers (Parts 2 & 3) through the decking into the threaded inserts of the H-beam and tighten.

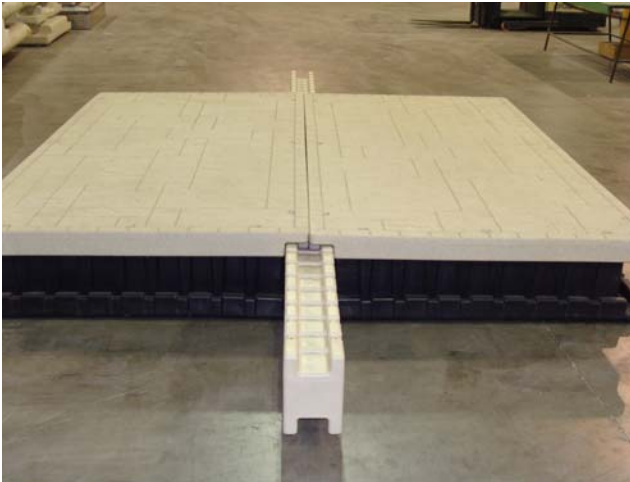

5. Repeat with another 50” H-beam on the other side of the dock sections.
6. Repeat steps 1–5 to complete another long-side-attached assembly.
7. Holding the two assemblies together, slide a 24” H-beam (Part C) into the channels of the two assemblies, making sure to insert the end of the H-beam with four threaded inserts first .
8. Gently pound the H-beam into the channels as far as it will go. Position another 24” H-beam in the channel and gently pound it in to move both H-beams through the channels of the dock sections until the threaded inserts of the first H-beam are aligned with the holes in the decking of the two dock sections. The threaded inserts of the second H-beam should also now be aligned with holes in the decking on the outside of the assembly. Insert a bolt and washer (Parts 2 and 3) thru the decking into the H-Beam using 2 bolts and washers per H-Beam.
9. Repeat with two more 24” H-beams on the other side of the assemblies.



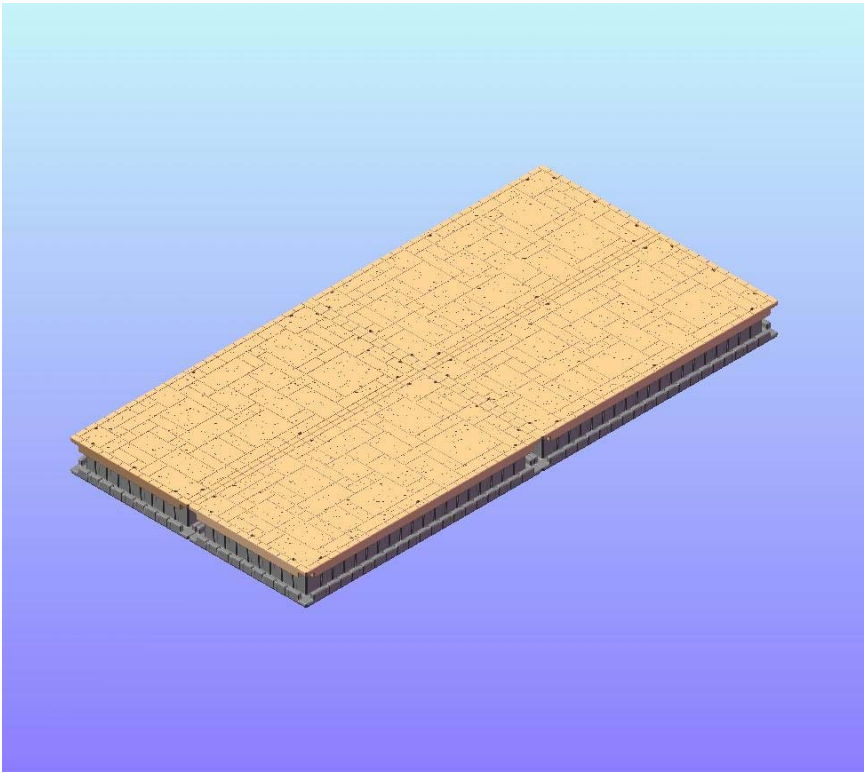

Four Dock Sections together to  
form 10ft x 20 ft section

### **Assemble Corner Gusset to Dock Section**

*The corner gusset is attached with built-in H-beams and does not need to be bolted.*

*Because of the built-in H-beams, when working with corner gussets, the order and direction of assembly is critical. See **Sample Layout Orders of Assembly** at the end of these instructions for examples and recommendations.*

1. Slide the corner gusset (Part B) into the channel of the long side of a dock section until the outer edges are aligned.
2. Slide this assembly into the channel of the long side of another dock section, making sure the corner gusset is inserted first (see diagram).

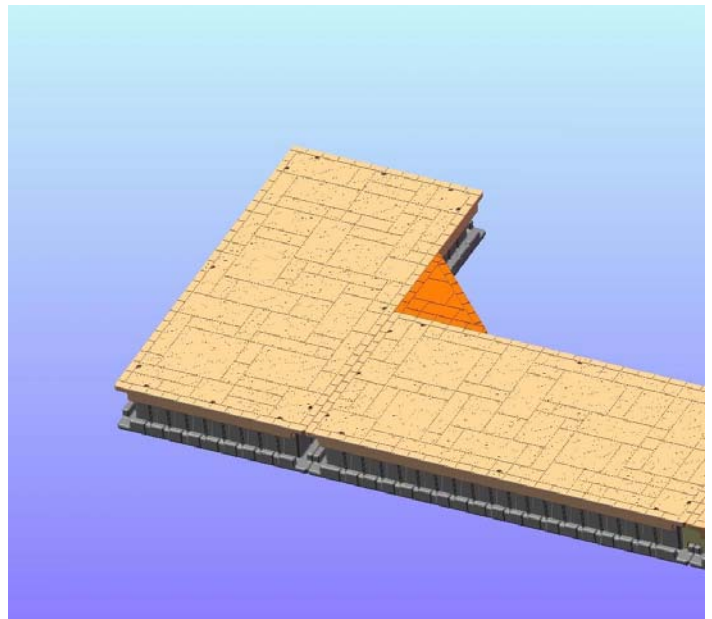
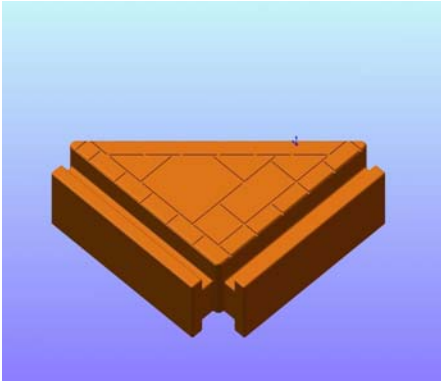

## Attach Accessories

### ***Attach Dock Post Attachments to Dock Section***

*2" Schedule 40 pipe or other pipe with a 2-3/8" outer diameter is recommended for use with the Wave Dock. For 4-6" pilings, use the post attachment without the pipe adapter.*

3. Using your dock layout plan, determine where posts will be located. It is recommended to place a post every 15-20 ft on each side of the dock and on the inside and outside corners of L-shapes.
4. Slide a post attachment (Part E) into a side channel of a dock section to the desired location, making sure to line up one of the threaded inserts with a hole in the decking (although there are two holes in the post attachment, you only need to use one). Use a mallet if necessary.
5. Insert a bolt and washer (Parts 2 & 3) through the decking into the threaded insert of the post attachment and tighten.
6. Insert a pipe adapter (Part F), long end first (see diagram), into the post attachment, lining up the holes with the threaded inserts in the post attachment.
7. Insert 3 bolts (Part 4) (3/8 x 3/4") and 3/8" washers (Part 3) through the holes of the pipe adapter and into the threaded inserts in the post attachment and tighten.



Post attachment slid into dock channel



Post Attachment and Pipe Adapter Attached to Dock Section

**Sample Layouts Only – May be configured into any layout desired**

