

## HA0172 ULTRABUNK LOADGUIDE AND PONTOON LOG RACK KIT

Fits 3000 to 7000 lb. aluminum vertical lifts including L models with aluminum or steel cradles

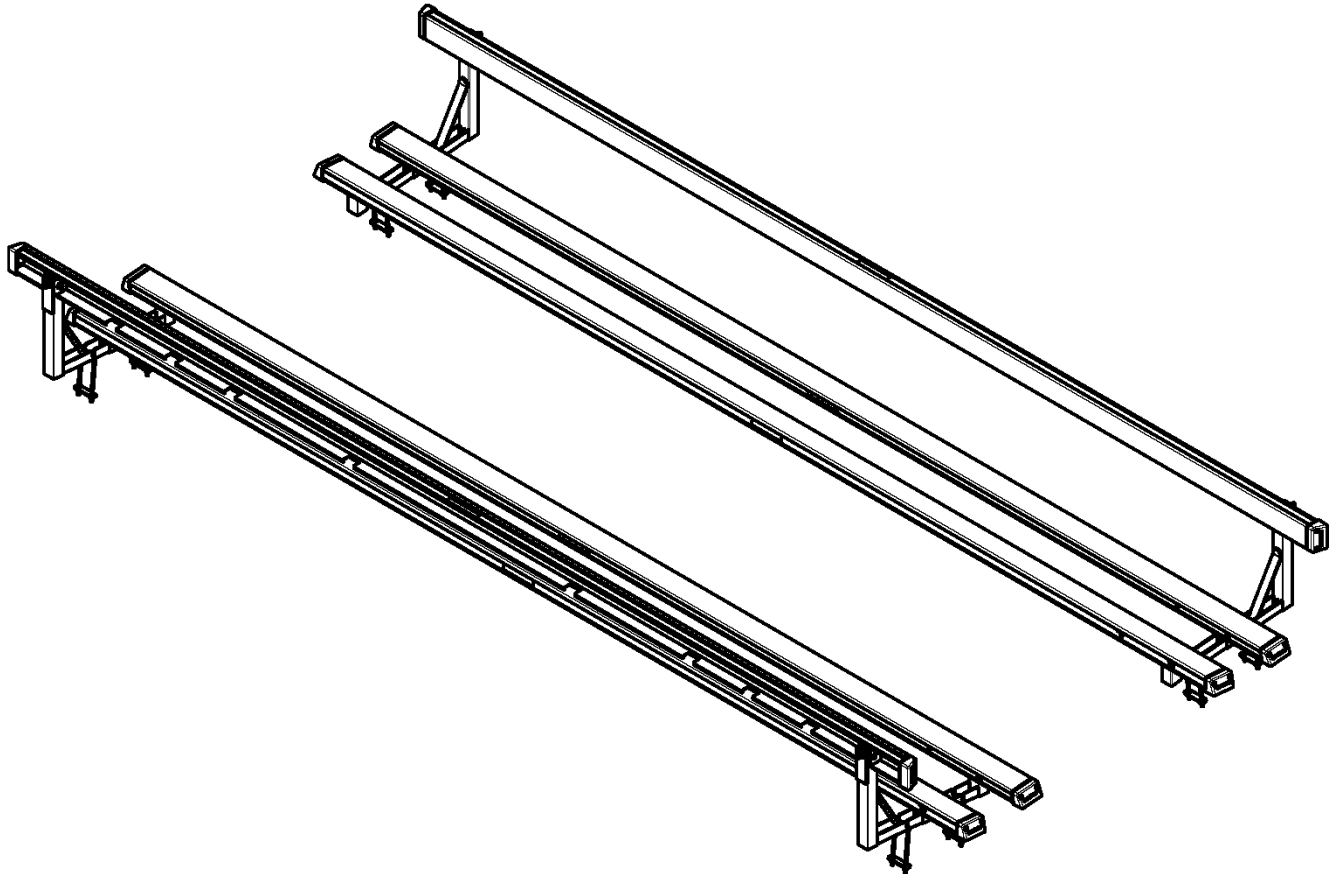

### **HA0172 Bundles**

71550	Load guide Bundle Log Rack Pontoon 180 Inch
7219803	Pontoon Log Rack Mounting Bundle
71536	Bunk Assy 15ft Poly

*Note: The maximum inside width (maximum beam) of the lift will be reduced by 7 inches when the mounting brackets are installed to their outer limits. If installed on lifts with a battery box or other obstructions, the assembly may need to be adjusted inward to avoid interference during the lift cycle.*



## Safety Instructions

- Always wear personal protective equipment (safety glasses, gloves, etc) when assembling and installing components.
- Inspect all fasteners regularly for deterioration and fastener tension. Refer to the exploded part views for fastener locations in the appropriate parts manual.
- Replace any and all components that show deterioration due to wear or misuse before installing or using your boat lift.
- Never modify parts and components. Always replace components with genuine ShoreStation replacement parts.

## Assembly Instructions

Remove the small parts from the frame by cutting the bands. Remove the bolt bag and sort all nuts and bolts by size.

Refer to the following pages for assembly instruction by components.

Start by placing a pontoon log rack weldment on the aluminum v-frame tube with the long tube to the outside of the hoist as shown. Place u-bolts in the slots allowing the threaded end to hang below the v-frame tube.

Slide a bracket over the threaded ends of the u-bolt and secure with flat washers and brass locknuts with nylon inserts. Repeat this process on the other three corners of your lift.

*Do not tighten at this time.*



Mount the bunks placing the stop bolt end in it to the entry end of the lift. Place the bunk over the mounting tube and align the hole in the bracket with the hole in the tube. Insert a stainless steel hex bolt thru the bracket and the tube and secure with a flat washer and brass

locknut with nylon insert.  
Repeat this process on the other three bunks on the entry end of the lift.

On the other end of the lift slide the mounting bracket in the bunk until it makes contact with the tube on the log rack weldment.

Align the hole in the bracket with the hole in the tube insert a stainless steel hex bolt. Secure with a flat washer and brass locknut with nylon insert. Repeat on the other bunks.



Mount the right and left loadguide extrusions to the uprights and aligning the holes. Insert stainless steel hex bolts and secure with flat washers and brass locknuts.

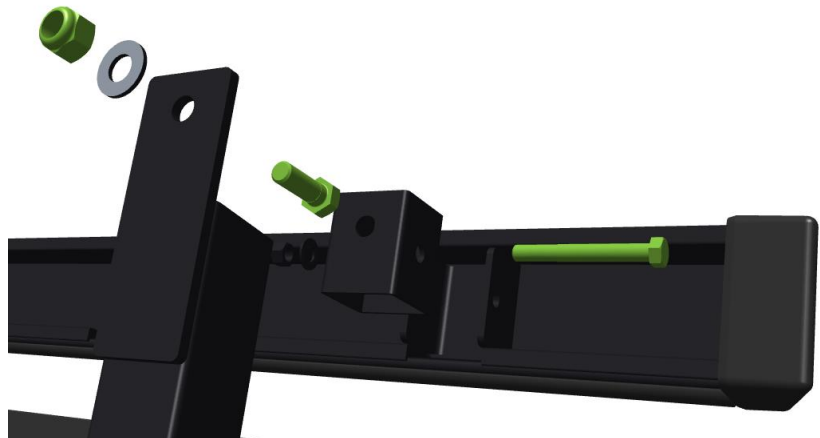

Measure the distance from center of float tube to center of the float tube on the pontoon boat. Slide the log rack weldments in or out until that measurement is centered between the bunks. Now tighten the u-bolts securing the weldments in place. Tighten the bolts holding the bunks in place only enough to maintain their position they should be able to rotate side to side to contour to the shape of the pontoon. The loadguides should be secured the same as the bunks.

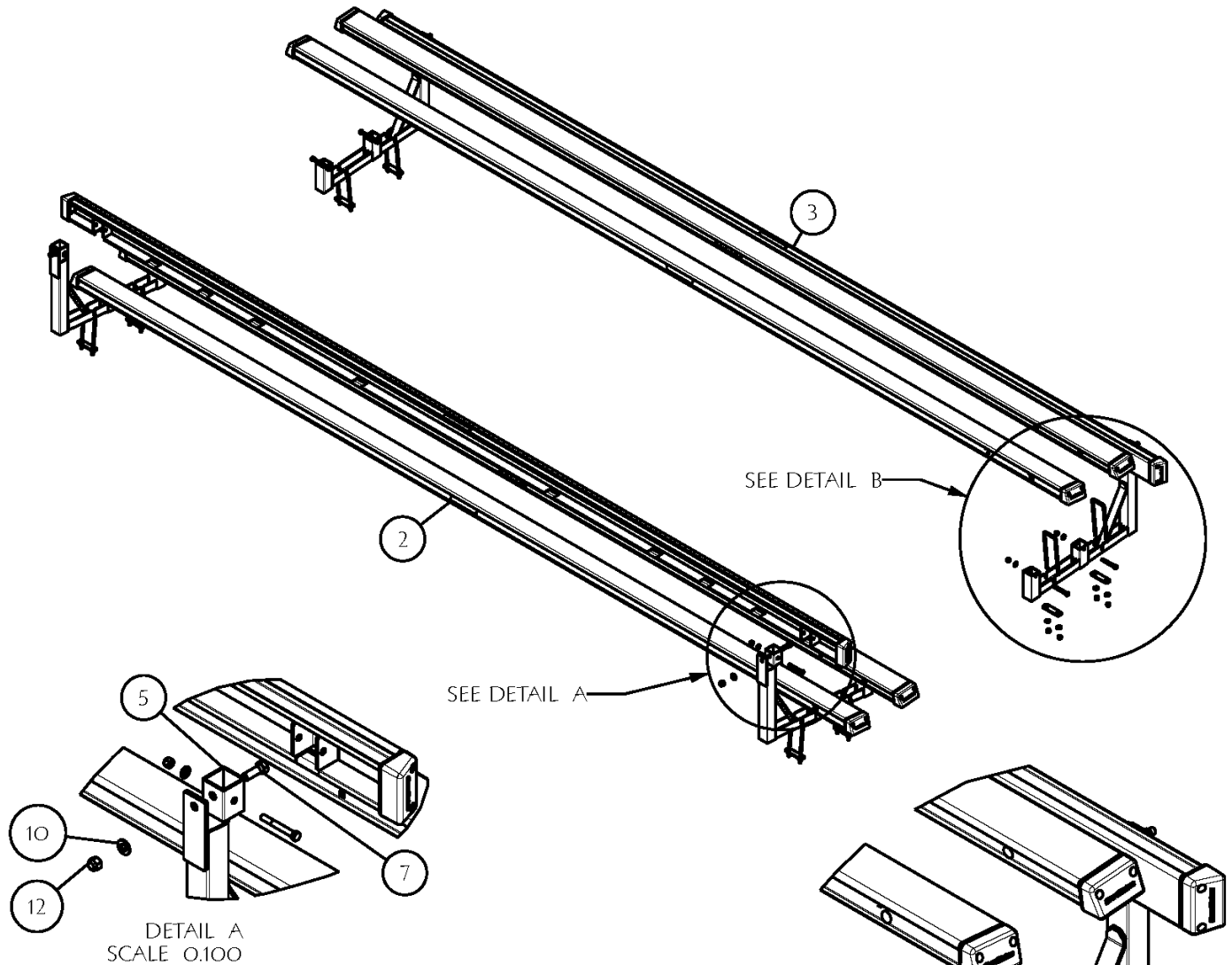

DETAIL A  
SCALE 0.100

DETAIL B  
SCALE 0.100

ITEM	PART #	DESCRIPTION	QTY	NOTE
1	70256	BRACKET - MOTOR STOP TOP	8	
2	71536	BUNK ASSY 15FT POLY	4	
3	71547	LOADGUIDE ASSY RT/LT LOG RACK 180 INCH	2	
4	72197	WMENT - PONTOON LOG RACK	4	
5	72271	LOG RACK VERT TUBE 1	4	
6	0150054	HH 3/8-16 X 3 CS GR5 STAINLESS	12	
7	0150281	HH 1/2-B X 1-1/2 CS SS GR5	4	
8	0350404	SUB 3/8 X 2 5/8 X 7 1/2 SS	8	
9	1350095	WASHER USS FLAT 3/8 STAINLESS	28	
10	1350100	WASHER USS FLAT 1/2 STAINLESS	4	
11	1440366	HEX LOCKNUT 3/8 BRASS/NYLON INSERT	28	
12	1440367	HEX LOCKNUT 1/2-13 BRASS/NYLON	4	