

3800 LB. ALUMINUM VERTICAL LIFT PARTS LIST (AS OF 2021) L0AH38

- (4) LONG BASES NAHL3807
- 3800 REGULAR — (2) CROSS BASES NAHL3808
- 3800W X-WIDE — (2) CROSS BASES NAHL3808W

(4) UPRIGHTS

CORNER UPRIGHT NAHL3804
84" 3 x 3

CORNER UPRIGHT NAHL3803
84" 3 x 3

CORNER WINCH UPRIGHT NAHL3801
84" 3 x 3

CORNER UPRIGHT NAHL3802
84" 3 x 3

Note: Numbers are
engraved in the
bottom of corner
posts.

(2) CROSS BEAMS

3800 LB
REG [NAHL3805 W/SINGLE CABLE
NAHL3806 W/DOUBLE CABLE

3800W LB
X-WIDE [NAHL3805W W/SINGLE CABLE
NAHL3806W W/DOUBLE CABLE

(2) LONG BEAMS NAHL4610

(2) WOOD KEEL BOARDS - LCRK

(2) CARPETED BUNKS - LFLB121

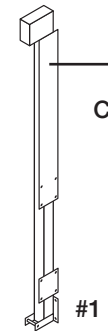
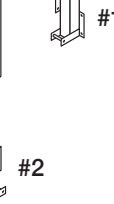
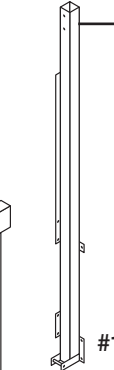
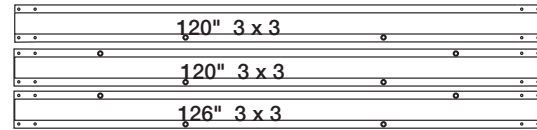

• • (02) 115-1/2" 2 x 5" (01) • •

• • (04) 115-1/2" 2 x 5" (03) • •

• • (02) 121-1/2" 2 x 5" (01) • •

• • (04) 121-1/2" 2 x 5" (03) • •

• • 107-5/8" 1-1/4" x 5" • •

• • 24"

2" X 6" X 12"

BED CORNER AND SLIDE BAG - NAHLCHB

(4) HL Bed Slide Bracket - NAHLBSB

(4) Inside Corner Bracket - NAHLICB

HARDWARE IN BAG NAHL3812

- (8) 3" x 14" x 1/4" Cradle Side Plates - LCRSP14
- (4) 2" x 2" Cradle Blocks - LCRB2
- (4) Reinforcement Plate - LCRKP
- (1) 2" Tear Drop Pulley - LIP2T
- (1) 3/8" x 3-1/2" Chain Bolts - NB38312CH
- (1) Spinner Knob Only - LKNOB1
- (4) 3/8" X 4" Leg Pins w/Clips - LLP4
- (14) 1/2" Nuts (Steel) - NN12S
- (12) 3" x 3" Plastic Plugs - D1PC3SQ
- (1) Assembly Instructions - NAASSYH26
- (1) Winch Instruction - WHWI
- (1) Moisture Bag
- (1) Winch Clamp - LDLWC

- (1) BOLT BOX - NAHL38BB
- (48) 3/8" x 1" SS Bolts - NB381G
- (2) 3/8" x 1-1/4" SS Bolt - NB38114FT
- (4) 3/8" x 2" SS Bolts - NB382G
- (1) 3/8" x 2-1/2" SS Bolt - NB38212G
- (8) 3/8" x 3" SS Bolts - NB383G
- (12) 3/8" X 3-1/2" SS Bolts - NB38312G
- (2) 3/8" x 4" SS Bolts - NB384G
- (4) 3/8" x 2-1/2" SS Carriage Bolts - NB38212C
- (8) 3/8" x 7-1/2" SS Carriage Bolts - NB38712C
- (3) 3/8" SS Washers - NW38FL
- (90) 3/8" Brass Nuts - NN38S
- (4) 1/2" x 2-1/2" SS Bolts - NB12212G
- (5) 1/2" SS Washers - NW12FL
- (8) 3/8" x 1-1/2" Bolts - NB38112G
- (8) Nylock Nuts - NN38N

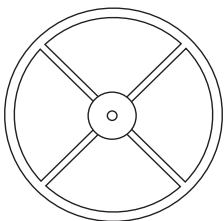

(1) 40" WINCH WHEEL
LWWL

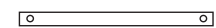

(4) CORNER BRACES
NAHL4609
30-1/2" x 3/4" x 3/4"

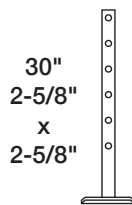

(4) LEVELING LEGS LLH31

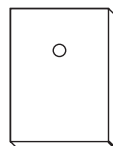

(1) WINCH 1501
LWHW15

"Quality Since 1971"

HEWITT MACHINE & MFG, INC. Box 111 Nicollet, MN 56074 (507) 225-3421

www.hewittrad.com

PAGE 1



NOTES: Each cross base and long base has a number at one end that corresponds to the corner upright it attaches to, NAHL3804 or NAHL3802. Simply match these numbers to assemble the main frame. Use washers on all slotted holes.

1. Slide leveling legs into corner uprights and secure with 3/8" x 4" leg pins.
2. Attach cross bases to corner uprights with 3/8" x 1" bolts and nuts.
3. Attach long bases to corner uprights using 3/8" x 1" bolts and nuts.
4. Attach corner braces using 3/8" 1-1/2 bolts with nylock nut for each brace.
5. Remove bolt from small end of tear drop pulley. Place link of chain bolt between pulley side plates and reinsert bolt. Do not overtighten, pulley must turn freely. Insert chain bolt into corner winch upright and secure with 3/8" washer and nut.
6. Mount winch on corner winch upright. **Step 1:** Attach winch clamp to winch box using two 3/8" x 1-14" hex bolts and secure with two 3/8" nuts. **Step 2:** With winch attached to the winch clamp slide winch clamp over the winch arm so the clamp sits above the welded stop and secure with two 3/8" x 4" hex bolts and use 3/8" brass nuts. Use the holes closest to the winch.

Note: 3" canopy leg is used to secure canopy extension if canopy is being installed.

7. Attach wheel to winch and attach spinner knob to wheel.

WINCH CLAMP INSTALL

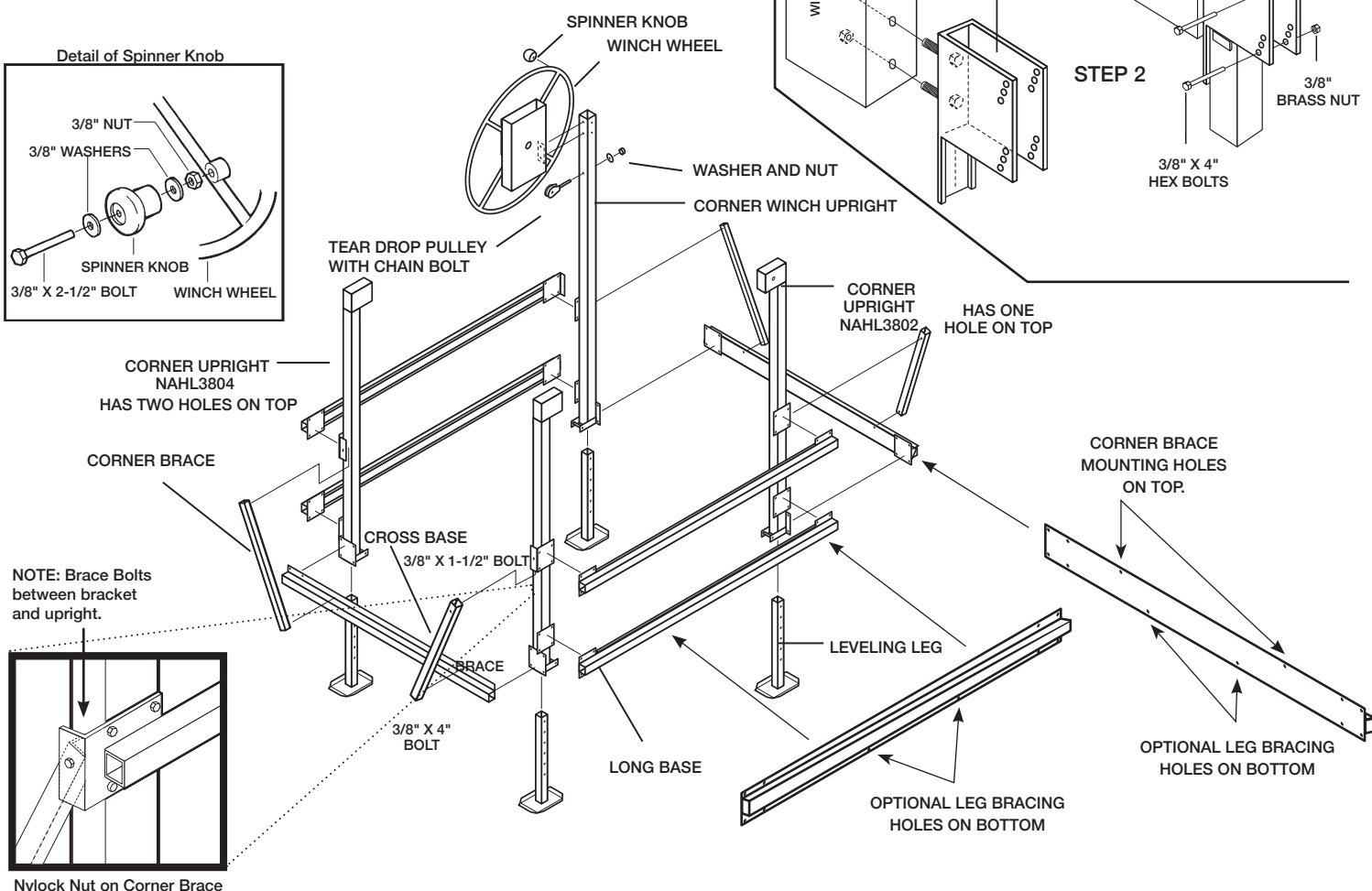
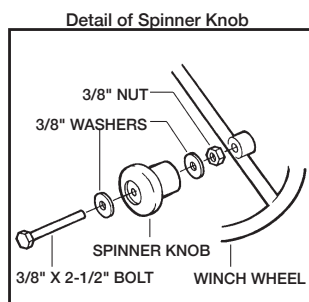
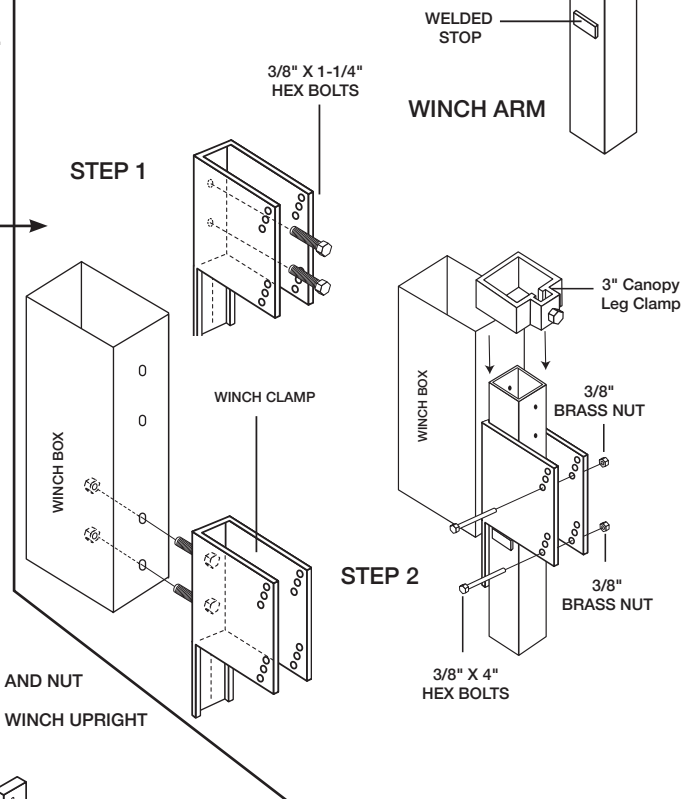

3800 VERTICAL LIFT LIFT BED ASSEMBLY INSTRUCTIONS

NOTE: One end of each cross beam and long beam is labeled with the corner upright number it corresponds to, NAHL3804 or NAHL3802. To assemble the lift bed and correctly position it within the main frame, simply match the numbers.

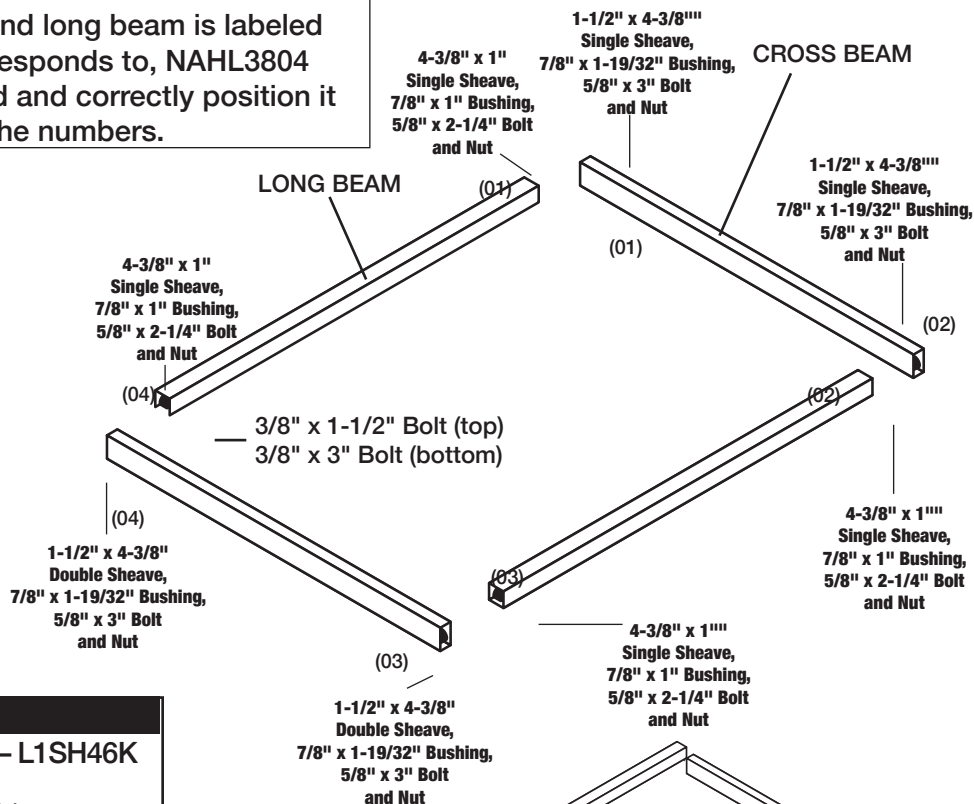
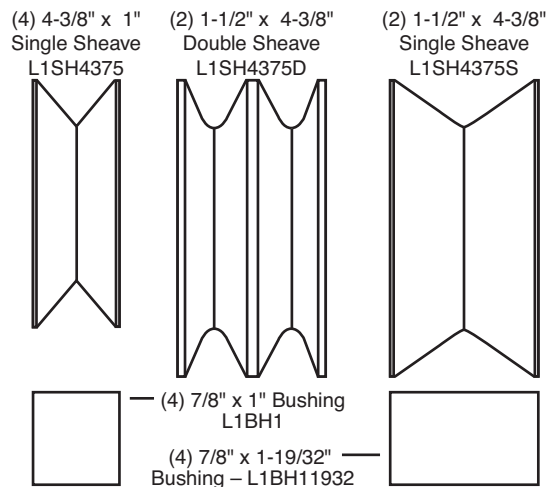

Replacement Sheaves and Bushings

3800/4600 HL Sheave and Bushing Kit - L1SH46K

(Kit includes all Bushings and Sheaves for lift)
(Sheaves and Bushings can be order individually)

Replacement Bolts and Nuts for Sheaves

5/8" x 3" Bolt - NB583G (4)

5/8" x 2-1/4" Bolt - NB582141S (4)

5/8" Nut - NN58S (8)

1. Attach cross beams to long beams using the inside corner Bracket and Slide Bracket. Cross beam with single cable should be positioned at the winch end of the lift. Remove nuts from long beam pulley bolts. It maybe necessary to remove this bolt and reinstall it so the bolt is inserted from the outside of the bed. After matching cross beams to long beams, replace nuts. (See detail illustration.)

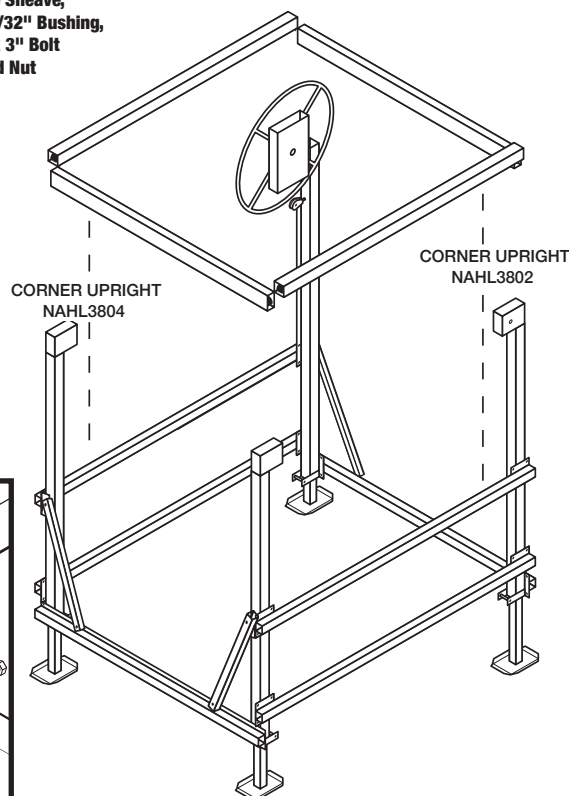
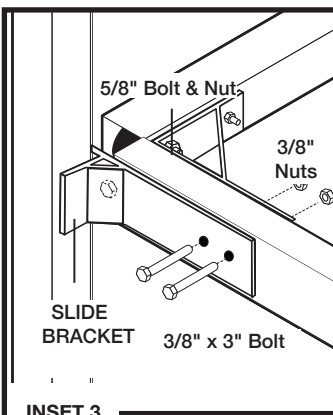
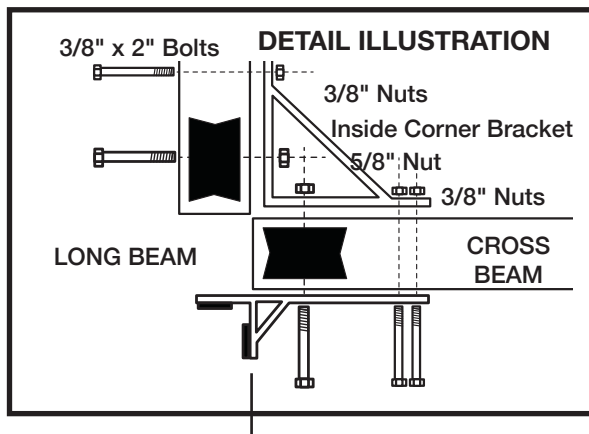

3800 REGULAR VERTICAL LIFT CABLE ASSEMBLY INSTRUCTIONS

1. Route cables as shown.
2. Attach cable ends identified in drawing as A, B, C, and D to bottom bracket on corner uprights. (see inset 1).
3. Attach cable ends E, F, G and H to top bracket on corner uprights. (see inset 2).
4. Attach cable end J to winch drum.

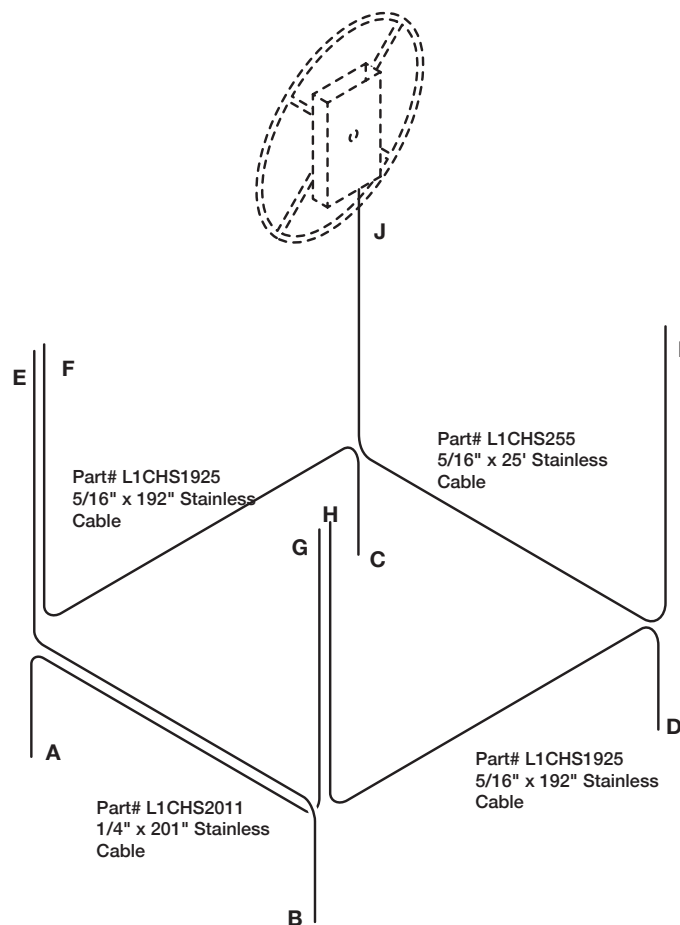
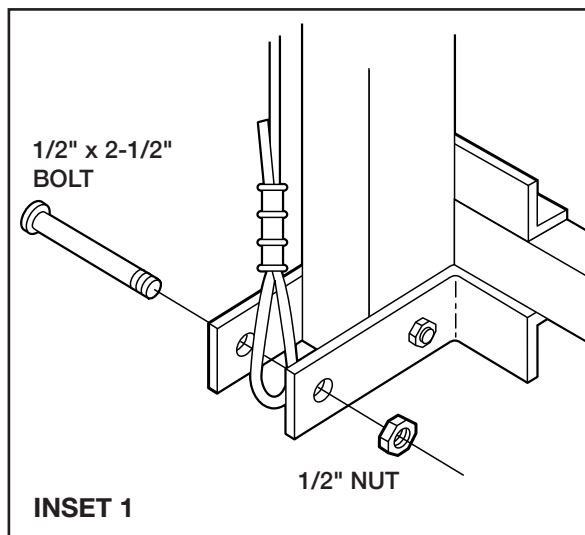

CORNER POST 3 and 4

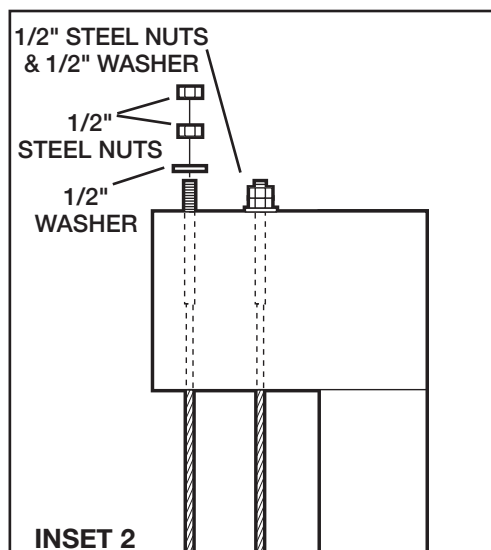

CORNER DETAIL

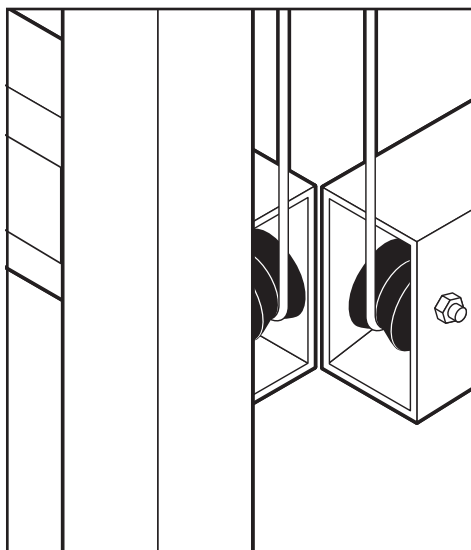

3800 X-WIDE VERTICAL LIFT CABLE ASSEMBLY INSTRUCTIONS

1. Route cables as shown.
2. Attach cable ends identified in drawing as A, B, C, and D to bottom bracket on corner uprights. (see inset 1).
3. Attach cable ends E, F, G and H to top bracket on corner uprights. (see inset 2).
4. Attach cable end J to winch drum.
5. Install corner roller and secure with 1/2" x 3-1/2" bolt and 1/2" Nylock nut. (see inset 3 & note).

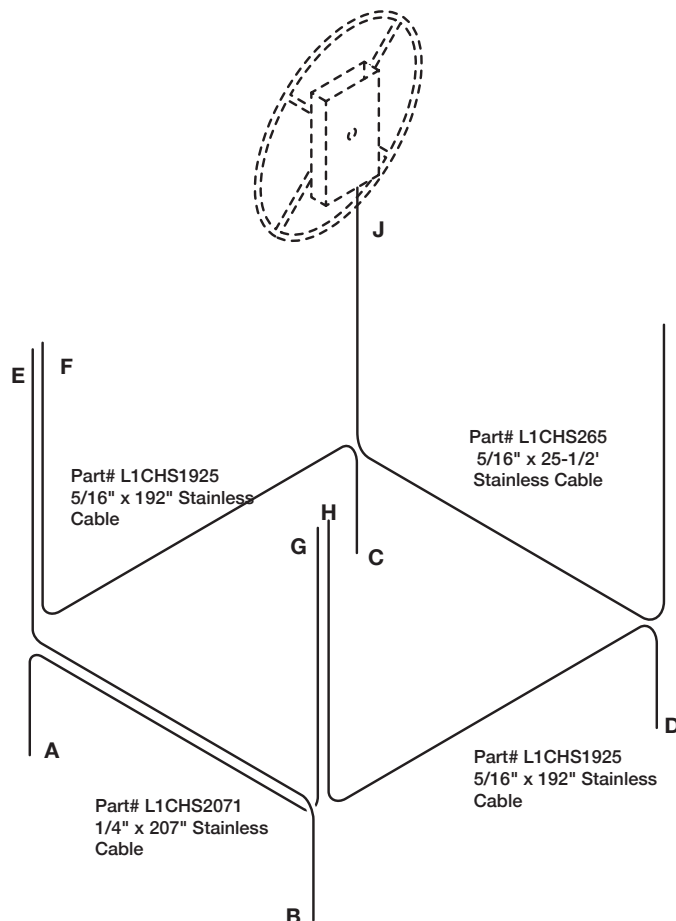
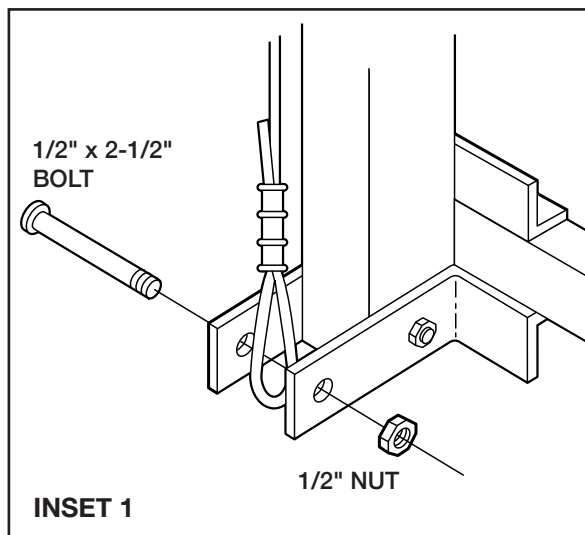

CORNER POST 3 and 4

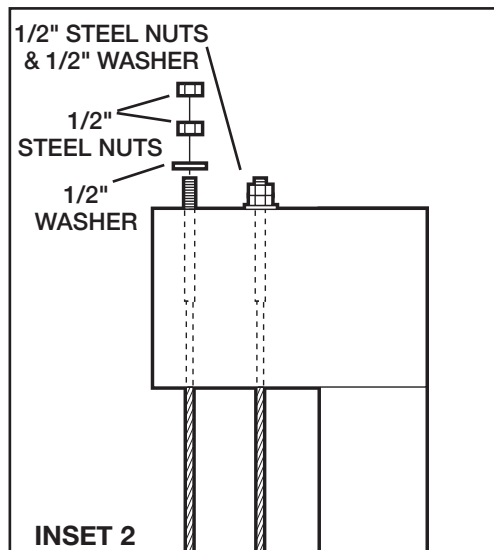

CORNER DETAIL

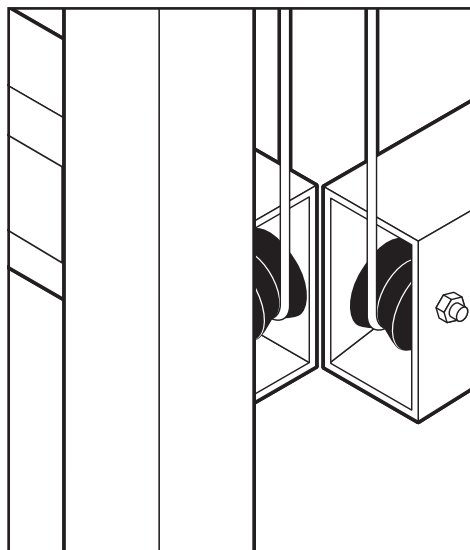

NOTE: DO NOT OVER TIGHTEN
Corner roller must turn freely.

3800 VERTICAL LIFT KEEL/CRADLE ASSEMBLY INSTRUCTIONS

1. Attach keel boards and bunks as shown.
2. Adjust as necessary.
3. Insert 3" x 3" plastic plugs in ends of long bases and cross bases.

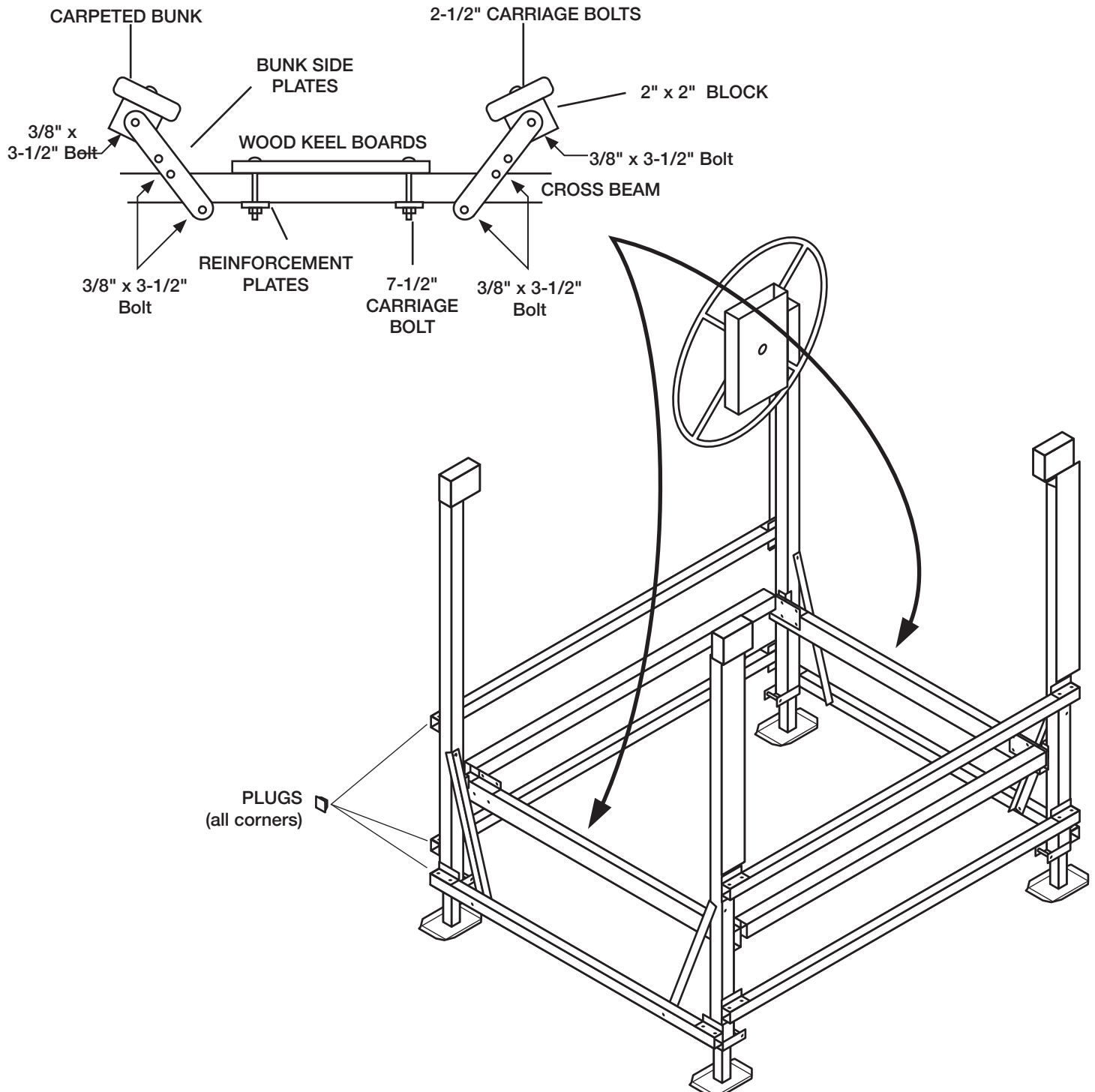

HEWITT

DOCKS - LIFTS - PONTOON LEGS

WINCH OPERATION: To lift, turn the winch wheel clockwise. The brake ratchet pawl should produce a clicking sound. The winch will hold the load at any position. To lower the load, turn the wheel counter clockwise. **NEVER LIFT HUMAN BEINGS ON THE LIFT. NEVER ALLOW HUMAN BEINGS UNDER THE LIFT OR LOAD AT ANY TIME.**

WARNING: To avoid injury, never lift the ratchet pawl from the ratchet wheel. It must stay in contact with the wheel at all times.

NOTES:

- Grease the cable and the bushings yearly for longer life.
- Periodically check that the pulleys are turning freely.
- When installing lift, the bed should be nearly level with the rear of lift, only slightly lower than the front.
- When placing the boat on the lift, make sure the boat is brought forward as far as possible without over running the lift. (The stem should be close to the back of the rear cross arm)
- When operating the lift, **DO NOT**, continue to crank the winch after the lift bed is fully down. Doing so will cause the cable to loosen on the winch drum causing the cable to tangle when rewinding.
- Allow your boat to float off of the lift framework completely before attempting to load or unload your boat from the lift. Do not power on or off.

WARRANTY

New HEWITT-built boat and pontoon lifts carry a 15 year conditional warranty on all aluminum and aluminum welds, and a 5 year conditional warranty on canvases, excluding fading.

HEWITT Machine and Manufacturing, Inc. further warrants all other parts used on HEWITT-built lifts and accessories, purchased new by the original owner, to be free from defects in the material and workmanship under normal use for a period of 24 months from the date of purchase (excluding components and options which carry their own manufacturer's warranty, wherein that warranty will apply). There is no other express warranty. HEWITT Machine and Mfg. Inc. is not liable for incidental or consequential damages or injuries of any kind due to installation, removal, use, misuse, misapplication or improper selection of one of our purchased or displayed products. HEWITT agrees to repair or replace only defective parts returned to the factory (prepaid) and deemed defective by HEWITT. Warranty is void when misuse or neglect is the cause.

Specifications are subject to change without notice.