

HA0057 & HA0058

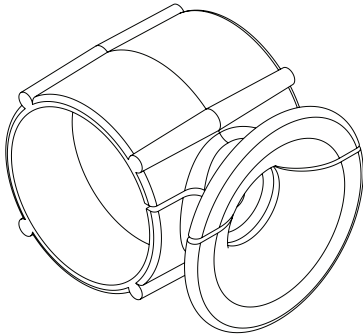

The split canopy cord spool hook kits are designed to be used when installing a new style vinyl cover on an old frame that is already assembled and is in the field.

The **HA0057** split canopy cord spool hook kit consists of enough canopy cord spool hooks, tie straps, and screws to fit a 26 ft. canopy cover. There will be additional parts left over when installing a new cover on an old frame that is shorter than 26 feet long.

The **HA0058** split canopy cord spool hook kit consists of enough canopy cord spool hooks, tie straps, and screws to fit all size canopies but is meant to be used on all old style frames larger than 26 ft. in length. There will be additional parts left over when installing a new cover on an old frame that is shorter than 40 feet long.

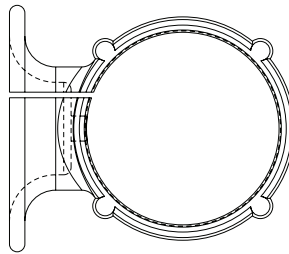
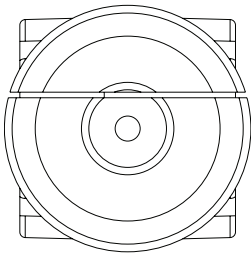

Installation Instructions

Remove the items from the hardware box and sort by size.

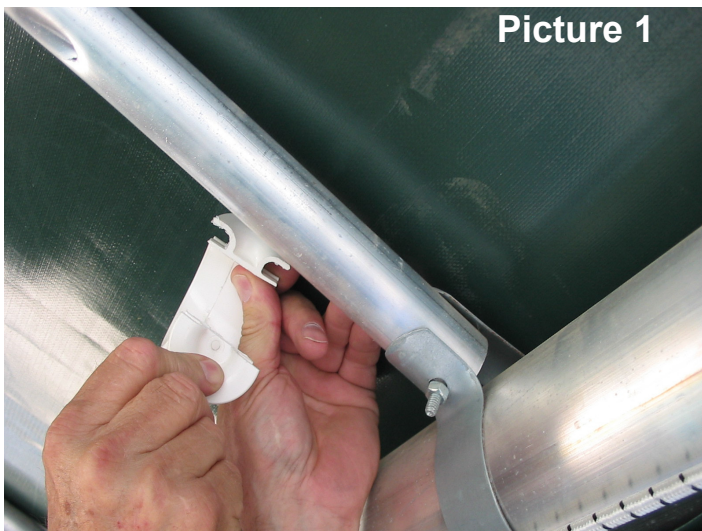

Picture 1



Picture 2

Canopy Bow Installation

Locate one of the split canopy cord spool hooks. Pry the canopy cord spool hook open until the split is opened enough to spread around the canopy bow.

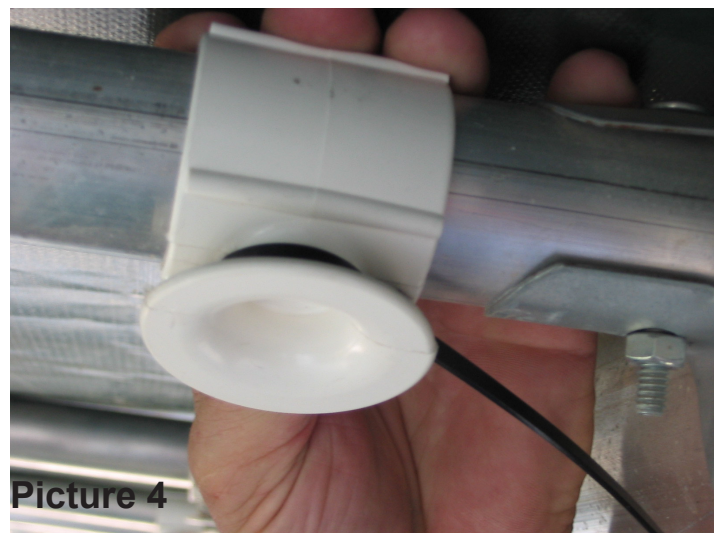
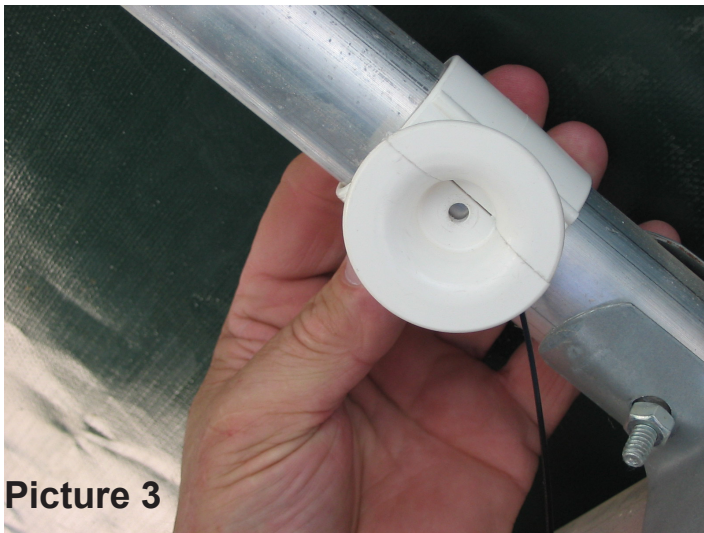

Picture 3

Picture 4

Once the canopy spool hook is around the canopy bow, place a tie strap around the spool section as shown. Pull the tie strap as tight as possible so the sides of the split section of the canopy spool hook are tight against each other.

Rotate the tie strap until the connecting portion of the tie strap is to the bottom..



Picture 5

Picture 6

Cut off the excess tie strap with a side cutter. Repeat this process on both sides of the canopy frame on all canopy bows that are not part of the end hood assembly.

Installation is complete unless you choose to connect the canopy spool hooks to the canopy bows with the self tapping screws provided.



Turn the canopy spool hooks so the spool portion is to the bottom side of the canopy bows. Locate the self tapping screws provided. Secure in this position by placing the self-drilling screw into the center hole of the spool, then drilling the screw in to attach it to the canopy bow.

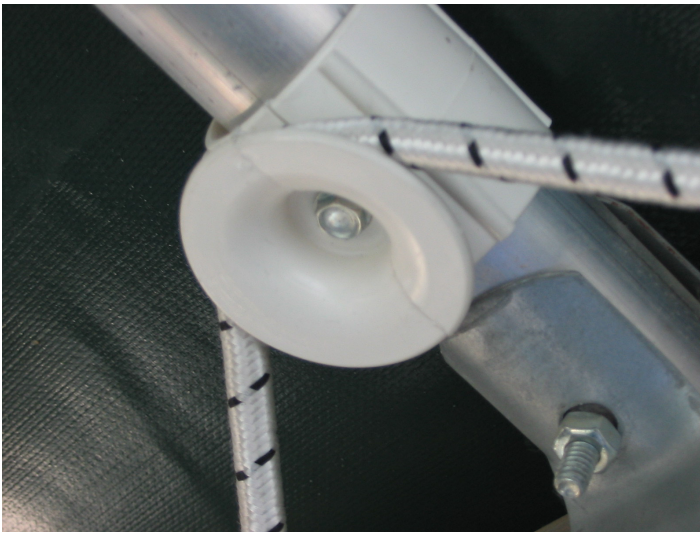

Assembly is now complete with the screw style mounting.

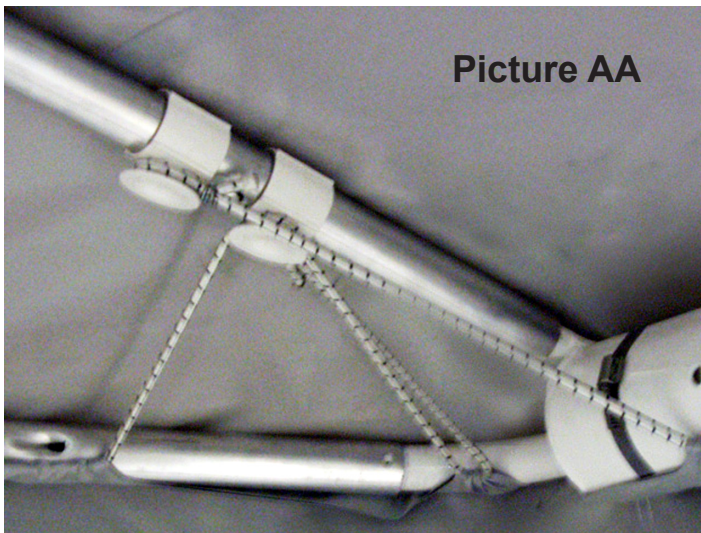

Picture AA

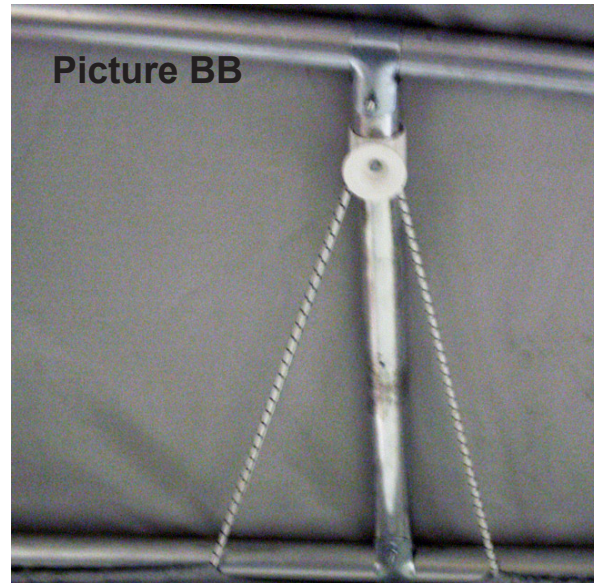

Picture BB

END HOOD INSTALLATION

Measure up from each end of the end hood canopy bow and place marks at both 7 ½" and 10 ½" from the end. See picture. Place two of the split canopy spool hooks on each end of the end hood canopy bows as shown. Secure canopy cord spool hooks together with the tie straps as described earlier in the canopy bow section.

Locate one of the No. 10 x ¾" self-drilling screws. Position the bottom edge of the canopy cord spool hook on the 10 ½" mark. Position so the spool of the molding is pointing directly down. Secure in this position by placing the self-drilling screw into the center hole of the spool, then drilling the screw into the canopy bow to secure it in place.

Place the bottom edge of the second canopy cord spool hook at the 7 ½" mark. Position so the spool of the molding is pointing directly down. Secure in this position by placing the self-drilling screw into the center hole of the spool, then drilling the screw in to attach it to the canopy bow.

Measure and place a mark at 2" from the top of each canopy end spacer tube as shown. Snap a split canopy spool hook over the canopy end spacer tube. Secure together using the tie strap as described earlier.

Position the top edge of the canopy spool hook so the top edge is at the 2" scribed line and the spool of the molding is pointing down. Secure in this position by placing the self-drilling screw into the center hole of the spool, then drilling the screw in to attach it to the canopy end spacer tube. Repeat on all other canopy end spacer tubes on both ends of the canopy frame.

The frame has now been converted over to where it will adapt to the new style cover. All extra spools supplied in the kit for the larger size frame are extra parts and will not be needed to install the cover.

INSTALLING THE NEW VINYL COVER TO THE FRAME

Remove the vinyl cover from the box. Unroll the vinyl cover down the side frame as shown. When completely unrolled, unfold the cover across the canopy bows and pull down over the framework.



The bungee cords are manufactured to the correct length before they are installed in the cover at the factory.

The installation process is as follows:

See Picture AA.

Stretch and attach the end loop on the side frame bungee cord over the rim of the plastic canopy cord spool hook attached at the 10 ½" mark.

Stretch and attach the end loops on the bungee in the end of the canopy to the canopy cord spool hook positioned at the 7 ½" mark in a similar manner.

Pull the end bungee cord from the next slot in the end strap back up and over the same canopy cord spool hook as shown. Repeat on the other side of the canopy.

See Picture BB.

Hook the center bungee up over the canopy cord spool hook located at the top of the center canopy spacer tube. Then hook over the canopy cord spool hooks at the top of the remaining spacer tubes.

Repeat this procedure on the other end of the cover making sure the cover is centered the same on each end.

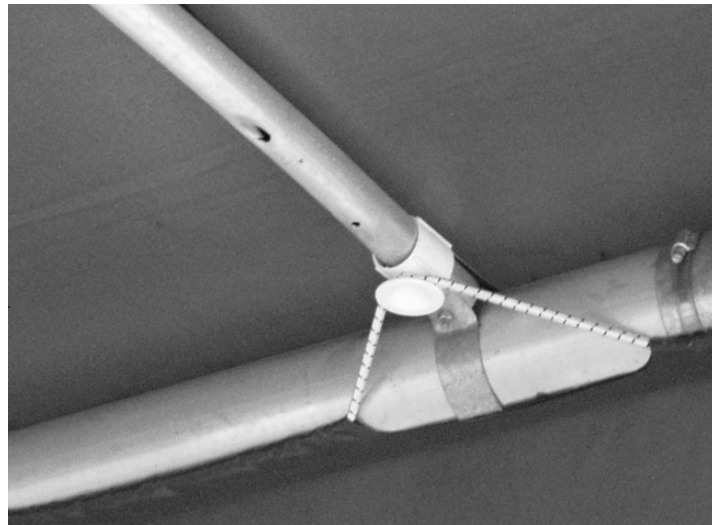

Starting at the middle of the side frames front to rear, pull the bungee cord on the sides of the canopy cover over the top side of the canopy cord spool hooks. Alternate from side to side of the canopy so the cover stays centered on the frame. Continue until they are all attached.

Once the bungee has been looped over all of the canopy cord spool hooks, check each one for adequate tension. The bungee can be pulled through the sewn in pocket so that the tension of the cord over each spool hook can be made even the full length and width of the cover.

Check for tension again. If bungee appears tight, assembly is complete.

If the bungees feel like they need to be tighter, they can be tightened by simply wrapping an additional wrap of the bungee cord around one of the canopy cord spool hooks. It may be tightened more by repeating this process on as many canopy cord spool hooks as needed.

CANOPY COVER (VINYL) MAINTENANCE

This canopy contains a mildew retardant. Please follow these recommendations to insure that this agent is not destroyed and that the vinyl will not be damaged.

1. Ordinary oil and dirt can be removed with soapy water such as laundry detergent. Apply with a mop, sponge, brush or cloth followed by a clear-water rinse. Stubborn spots can be removed by using rubbing (Isopropyl) alcohol in a well-ventilated area, away from open flames. **DO NOT USE** gasoline, kerosene, methyl ethyl Keytone (MEK) or other solvents or bleaches.

2. Remove canopy when hoist is in storage. Make sure canopy is dry before folding and store in a warm, dry location.

If the bungees feel like they need to be tighter, they can be tightened by simply wrapping an additional wrap of the bungee cord around one of the canopy cord spool hooks. It may be tightened more by repeating this process on as many canopy cord spool hooks as needed.

CANOPY END HOOD ADJUSTMENT

Your new canopy frame has adjustable end hood brackets which allow the frame to be adjusted a total of 1-1/2" shorter or 1-1/2" longer from its normal shipped position. This allows you to adjust your frame to fit the cover for length should it need adjusting. The following instructions will assist you in adjusting the frame length.

1. Loosen the nuts on the adjusting bolts located in the end of the side frame tube weldments. Doing so will shorten the overall length of the frame.

2. The frame can be lengthened to fit the cover by tightening the nuts on the bolts in the side frame tube stop weldments just loosened in Step 1.

Turn clockwise. As the nut is threaded onto the bolt it will pull the end hood out of the side frame thus increasing the length of the canopy framework.

Continue to lengthen the frame until it is the right length to fit the cover.

3. Once the proper length for the frame has been achieved, stop turning the nut.

Adjustment is complete.

WARRANTY

Refer to your **ShoreStation** Owner's Packet for warranty information.

