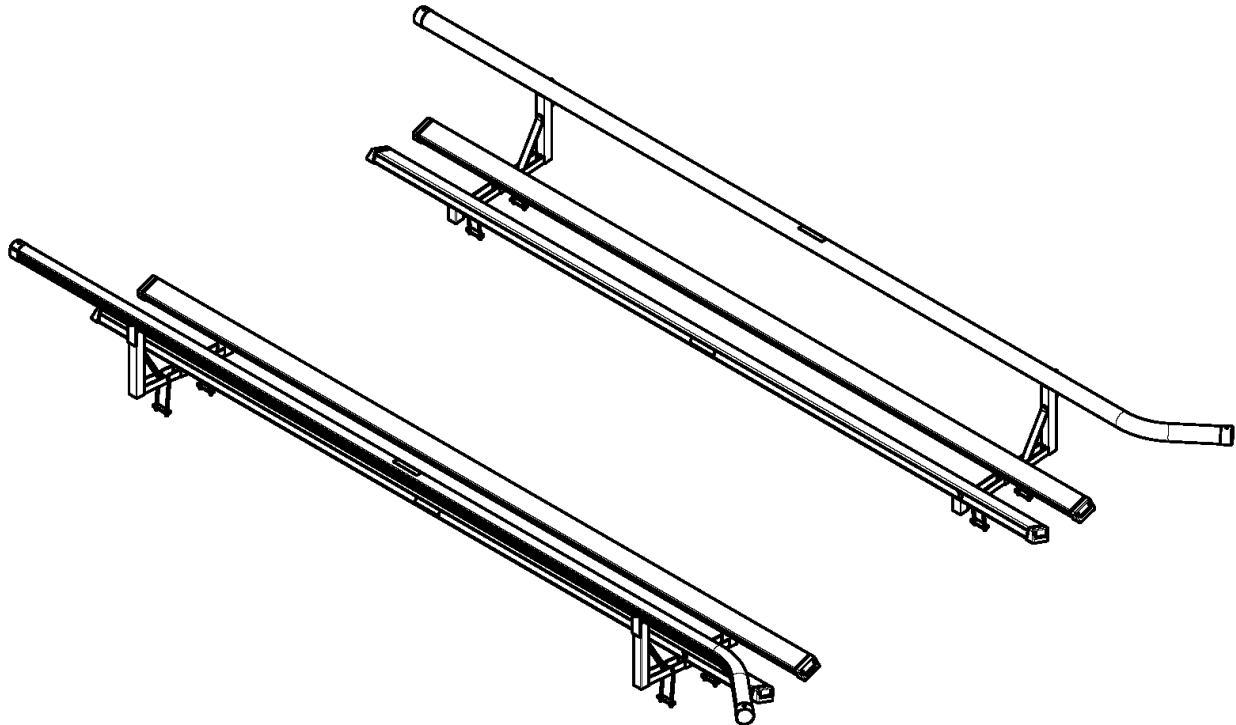

HA0219**GLIDERAIL 16.5FT LOADGUIDE PONTOON LOG RACK 15FT**

This kit will fit 3000 thru 7000 lb lifts including L models with steel or aluminum cradle tubes.

**HA0219****Bundles**

7222115	LOADGUIDE 16.5 FEET GLIDERAIL BUNDLE SAND BEIGE
7219803	PONTOON LOG RACK BUNDLE FOR GLIDERAIL HOIST
71536	BUNK ASSY 15FT POLY

Note: The maximum inside width (maximum beam) of the lift will be reduced by 7 inches when the mounting brackets are installed to their outer limits. If installed on lifts with a battery box or other obstructions, the assembly may need to be adjusted inward to avoid interference during the lift cycle.



Safety Instructions

- Always wear personal protective equipment (safety glasses, gloves, etc) when assembling and installing components.
- Inspect all fasteners regularly for deterioration and fastener tension. Refer to the exploded part views for fastener locations in the appropriate parts manual.
- Replace any and all components that show deterioration due to wear or misuse before installing or using your boat lift.
- Never modify parts and components. Always replace components with genuine ShoreStation replacement parts.

Assembly Instructions

Remove the small parts from the frame by cutting the bands. Remove the bolt bag and sort all nuts and bolts by size. Refer to the following pages for assembly instruction by components.

Start by placing a pontoon log rack weldment on the aluminum v-frame tube with the long tube to the outside of the hoist as shown. Place u-bolts in the slots allowing the threaded end to hang below the v-frame tube. Slide a bracket over the threaded ends of the u-bolt and secure with flat washers and brass locknuts with nylon inserts. Repeat this process on the other three corners of your lift. *Do not tighten at this time.*

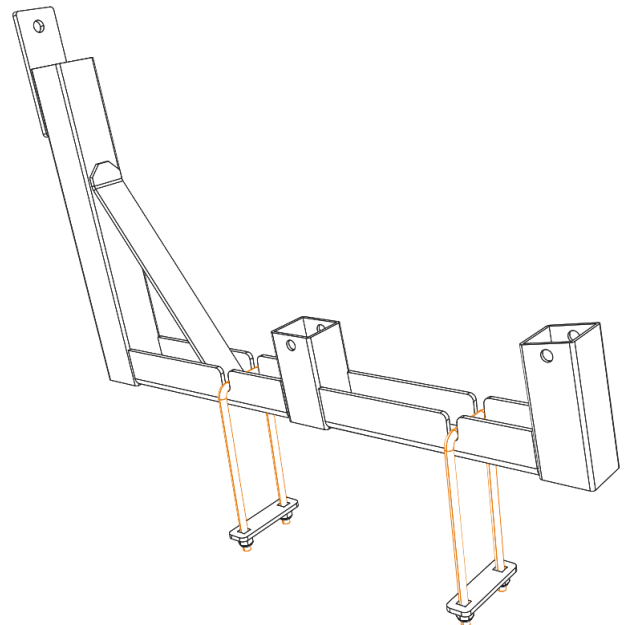

Mount the bunks placing the end with the stop bolt in it to the entry end of the lift. Place the bunk over the mounting tube and align the hole in the bracket with the hole in the tube. Insert a stainless steel hex bolt thru the bracket and the tube and secure with a flat washer and brass locknut with nylon insert. Repeat this process on the other three bunks on the entry end of the lift. On the other end of the lift slide the mounting bracket in the bunk until it makes contact with the tube on the log rack weldment. Align the hole in the bracket with the hole in the tube insert a stainless steel hex bolt. Secure with a flat washer and brass locknut with nylon insert. Repeat on the other bunks.

Measure the distance from center of float tube to center of the float tube on the pontoon boat. Slide the log rack weldments in or out until that measurement is centered between the bunks. Now tighten the u-bolts securing the weldments in place. Tighten the bolts holding the bunks in place only enough to maintain their position they should be able to rotate side to side to contour to the shape of the pontoon.

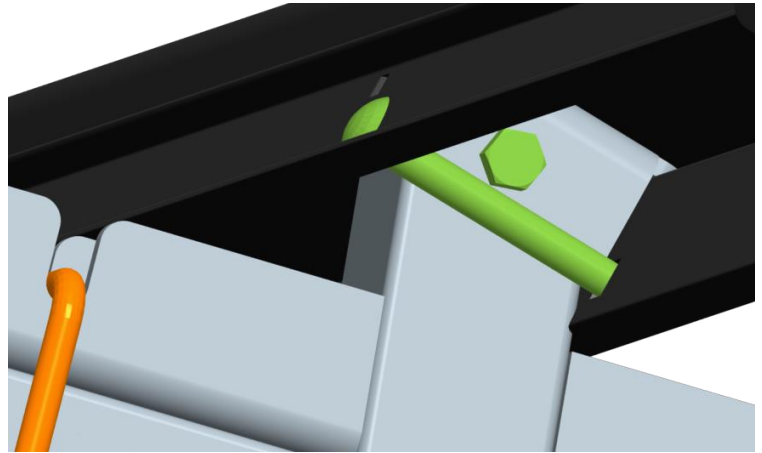

Insert stainless steel carriage bolts into the slot on the back of the Gliderail extrusion. Mount the Gliderail loadguide extrusions to the uprights and aligning the holes. Secure with flat washers and brass locknuts.



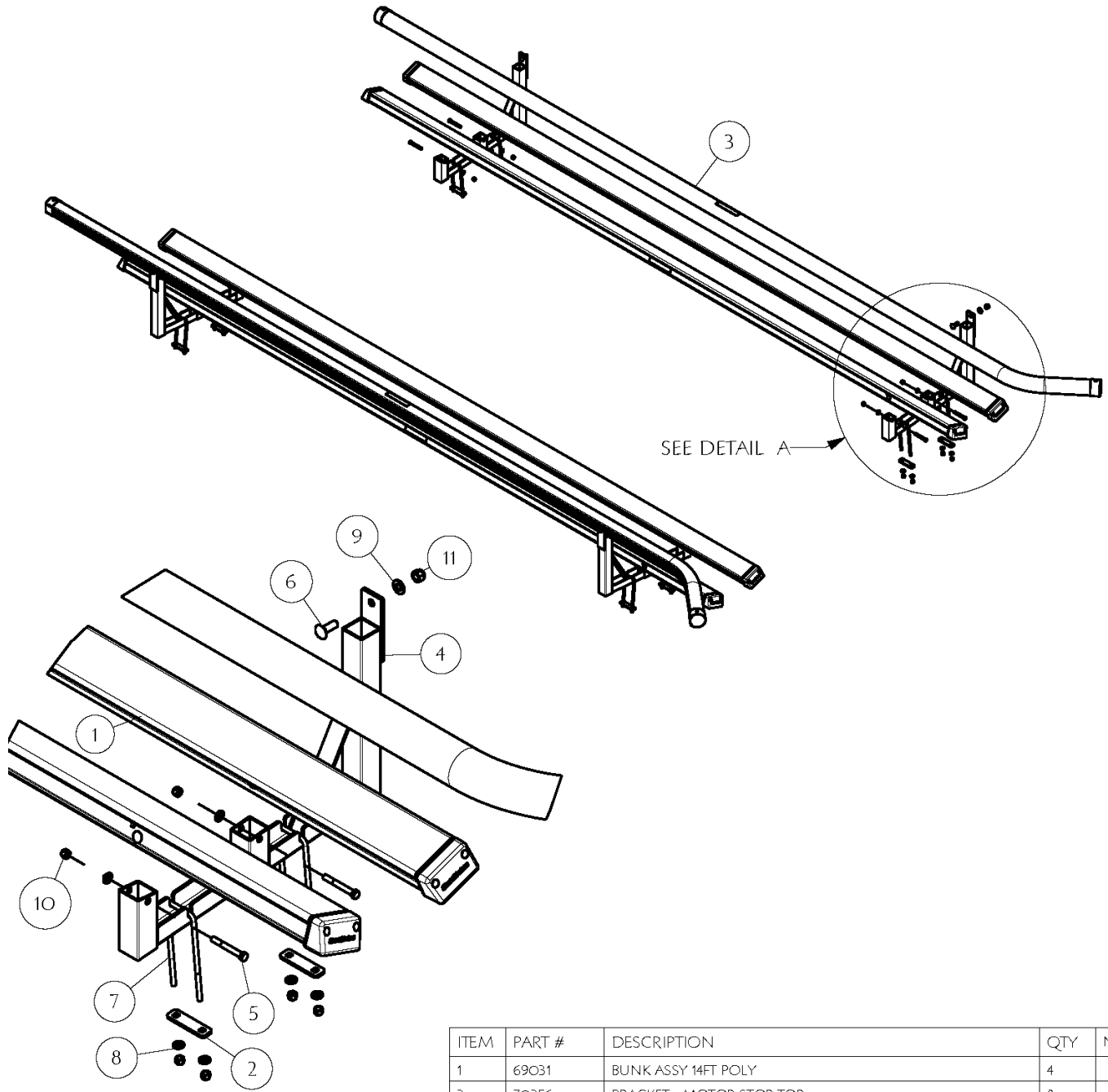

DETAIL A
SCALE 0.100

ITEM	PART #	DESCRIPTION	QTY	NOTE
1	69031	BUNK ASSY 14FT POLY	4	
2	70256	BRACKET - MOTOR STOP TOP	8	
3	71730	LOADGUIDE LIFT GLIDERAIL 200 IN ASSEMBLY NO MTG HDWE	2	
4	72197	WMENT - PONTOON LOG RACK	4	
5	0150054	HH 3/8-16 X 3 CS GR5 STAINLESS	8	
6	0250134	CARR 1/2-13 X 1-1/2 SS GR5	4	
7	0350404	SUB 3/8 X 2 5/8 X 7 1/2 SS	8	
8	1350095	WASHER USS FLAT 3/8 STAINLESS	24	
9	1350100	WASHER USS FLAT 1/2 STAINLESS	4	
10	1440366	HEX LOCKNUT 3/8 BRASS/NYLON INSERT	24	
11	1440367	HEX LOCKNUT 1/2-13 BRASS/NYLON	4	