

## HA0290 Interior Post Guides 8K HY – Top Cap Lift Tube



### **Application**

HA0290 fits 8,000 lb. ShoreStation freestanding Top Cap boat lifts. The Interior GlidePoles are designed to provide additional boat protection when entering the lift. They are mounted between the corner posts of the lift and may be adjusted to the best location for maximum boat protection. Interior GlidePoles can be used in conjunction with several other styles of GlidePole Load Guides that are mounted on the ends of the lift to create total front-to-back guide-on assistance that centers the boat and prevents damage. **Installing these Interior Post Guides will reduce the maximum boat width by 6 inches.**

### **Tools**

3/4 socket and wrench, 1/2 socket and wrench, cordless drill

### **Organize Parts**

Open the hardware box and bag, and sort the hardware and other contents by size.

## **1 – Bolts into GlidePole**

Slide two 1/2-13 x 1-1/2 bolts and one 1/2-13 x 3-1/2 bolt into the T-slot of a GlidePole. Insert the two shorter bolts through the long spacer plate. Put the GlidePole up against the lift tube with one short bolt above the lift tube and one below the lift tube. Also make sure the longer bolt is above the lower frame.

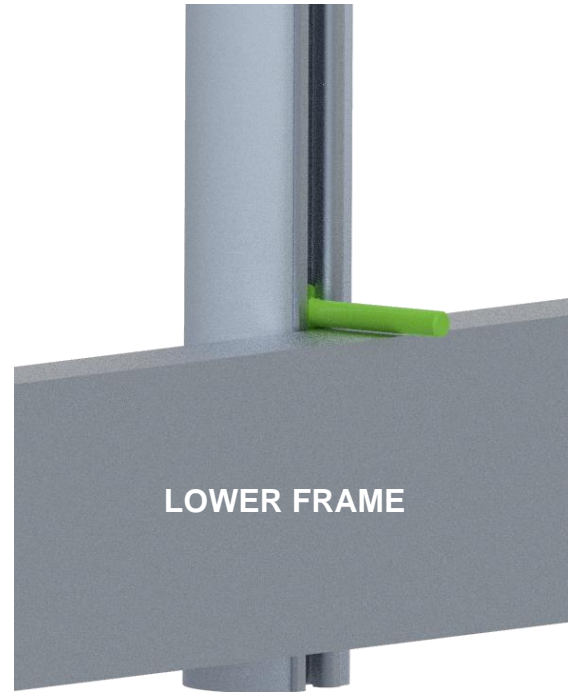
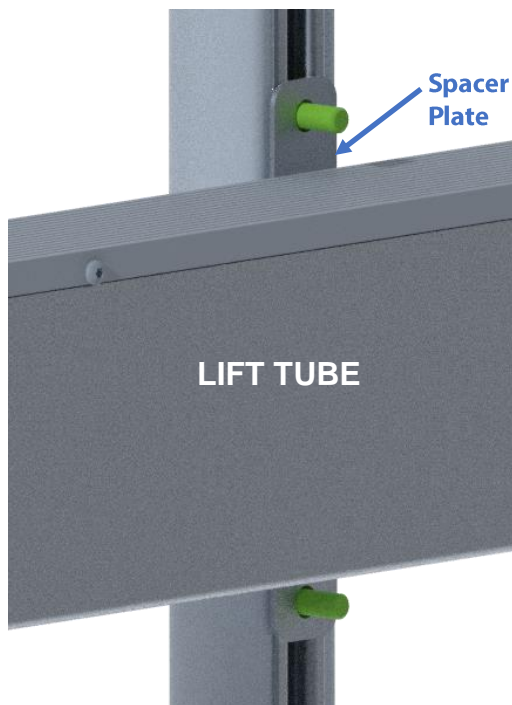

## **2 – Lift Tube Bracket**

Put the bracket around the lift tube, the washers on the bolts, and start the lock nuts as shown below.

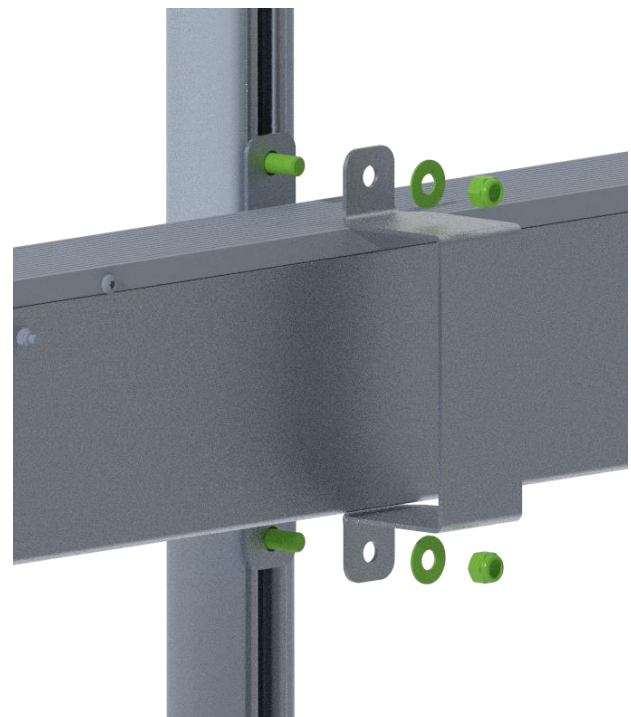

### **3 – Lower Frame Brace**

Slide a 1/2-13 x 3-1/2 bolt into the bottom of the GlidePole under the lower frame and put the bolts through the correct holes in the brace. Add the washers and lock nuts to the bolts. Make sure the GlidePole is straight vertical and tighten the lock nuts for the lower

frame brace and lift tube bracket.

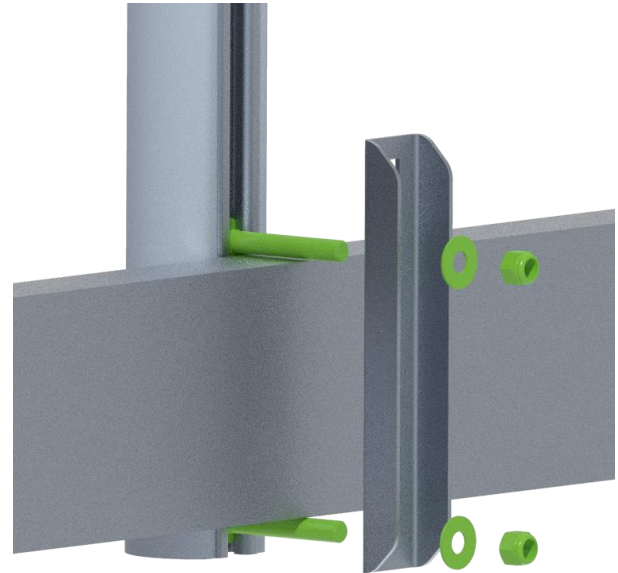

### **4 – Brace Tube**

Slide two 1/2-13 x 1-1/2 bolts and one 1/2-13 x 3-1/2 bolt into the T-slot of the other GlidePole. Insert the two shorter bolts through the shorter spacer plate. Put the GlidePole up against the brace tube with one bolt above the brace tube and one below the tube. Make sure the longer bolt is above the lower frame. Put the bracket around the brace tube, place washers on the bolts, and hand tighten the lock nuts as shown.

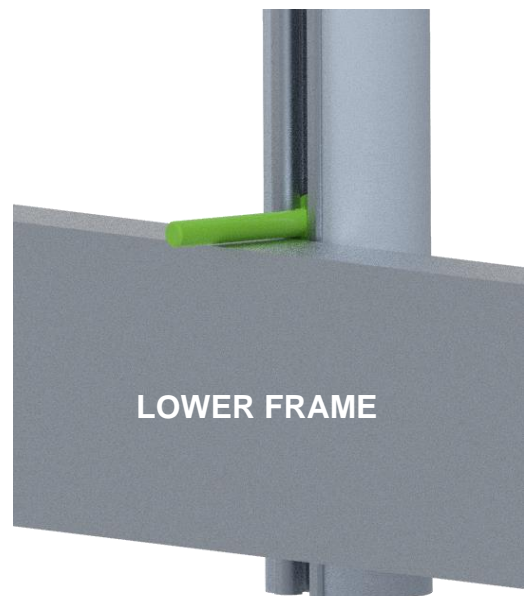
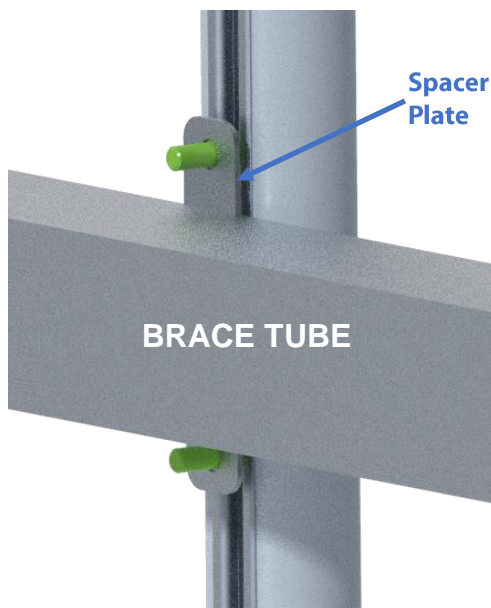

### **5 – Brace Tube Bracket**

Put the bracket around the lift tube, the washers on the bolts, and start the lock nuts as shown below.

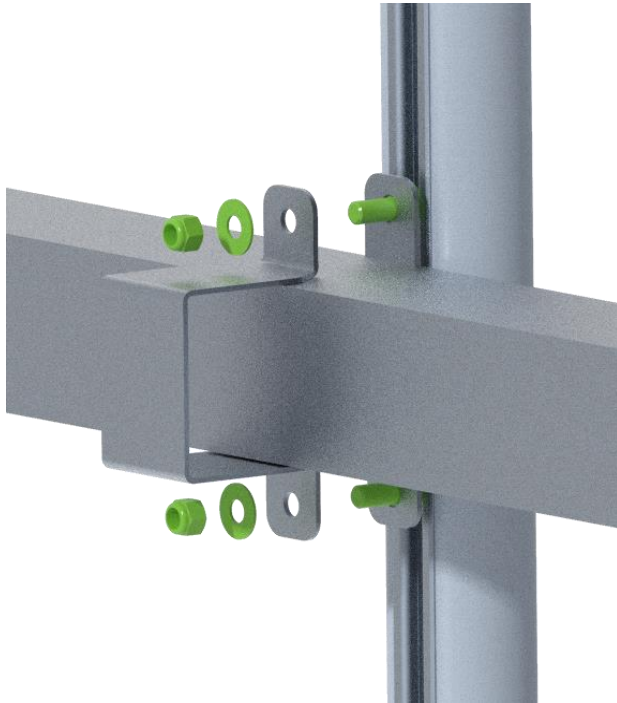

straight vertical and tighten the lock nuts for the lower frame brace and brace tube bracket.

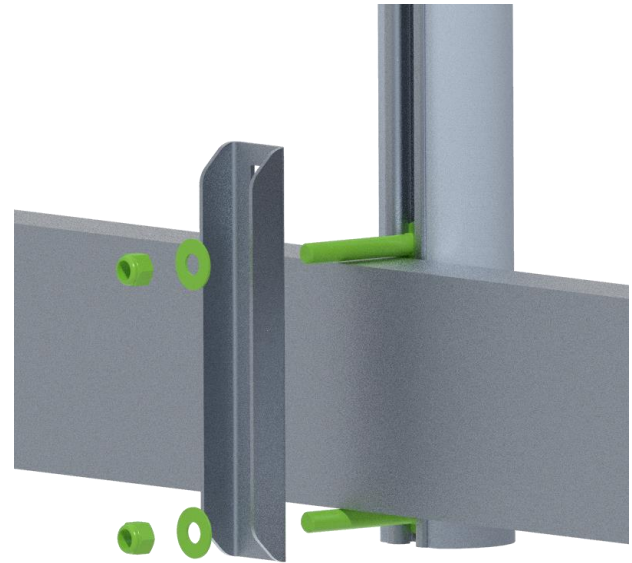

## **6 – Lower Frame Brace**

Slide a 1/2-13 x 3-1/2 bolt into the bottom of the GlidePole under the lower frame and put the bolts through the correct holes in the brace. Add the washers and lock nuts to the bolts. Make sure the GlidePole is