

Shore Station

SSAC2 INSTALLATION INSTRUCTIONS

Your new SHORE STATION SSAC2 ELECTRIC DRIVE is universal and will fit most boat hoists manufactured that are equipped with a large hand wheel.

SHORE STATION ALUMINUM MODELS

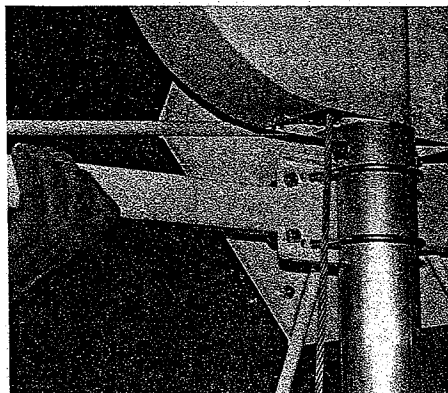

1. Position the mounting bracket (Ref. #20) with the notch on the upright post just below the winch case. Secure to post with large 3/8" (Ref. #3) round U-bolts and lock nuts (Ref. #10). Tighten to hold in position.

2. Insert 3/8" square U-bolt (Ref. #4) into mounting bracket

and secure with 3/8" lock nuts (Ref. #10). Slide aluminum spacer bar (Ref. #17) into square U-bolts.

3. Fasten mounting arm (Ref. #8) to drive unit with 5/16" x 1" head bolts and 5/16" lock nuts. Slip mounting arm into 3/8" square U-bolts making sure the aluminum spacer bar is behind the mounting arm (Ref. #8) next to mounting channel (Ref. #20) as shown in the above picture. Operate lever to place motor and pulley into the disengaged position. With motor in the disengaged position, slide the mounting arm through the U-bolts with the motor positioned to the right as you face the hand wheel until there is approximately 1/2" clearance between the outer most diameter of the large hand wheel and the bottom of the pulley groove. Tighten 3/8" square U-bolts. (Note: The bracket installed in step one may need to be rotated on the upright post so the large hand wheel and pulley groove align with one another.)

4. Engage the grooved pulley with the hand wheel. If pulley and hand wheel do not contact sufficiently the complete unit can be moved closer to the hand wheel by loosening 3/8" square U-bolts in step 3, then repositioning and tightening.

SHORE STATION STEEL MODELS

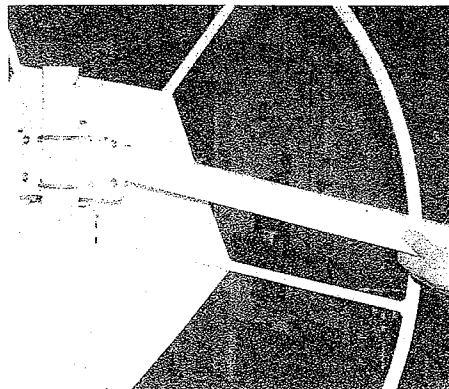

1. Position the mounting bracket (Ref. #20) with the notch on the tube above the winch case. Secure with the small 3/8" round U-bolts and lock nuts.

2. Insert the 3/8" square U-bolts (Ref. #4) into mounting bracket and secure with 3/8" lock nuts

(Ref. #10). Slide aluminum spacer bar (Ref. #17) into square U-bolts.

3. Fasten mounting arm (Ref. #8) to drive unit with 5/16" x 1" head bolts and 5/16" lock nuts. Slip mounting arm into 3/8" square U-bolts making sure the aluminum spacer bar is behind the mounting arm. Operate toggle to place motor in the disengaged position. With the motor positioned to the left as you face the hand wheel, the motor positioned below the mounting arm, slide the mounting arm through the U-bolts until there is approximately 1/2" clearance between the outer most diameter of the large hand wheel and the bottom of the pulley groove. Tighten the 3/8" square U-bolts. (Note: The bracket installed in step one may need to be rotated on the upright post so the large hand wheel and pulley groove align with one another.)

4. Engage the grooved pulley with the hand wheel. If pulley and hand wheel do not contact sufficiently the complete unit can be moved closer to the hand wheel by loosening 3/8" square U-bolts in step 3, then repositioning and tightening.

INSTALLATION ON OTHER MAKES OF HOIST

Other additional steps may be necessary to install on other brands of hoist.

IMPORTANT!

POWER SOURCE: Your new electric drive is powered by 110 volt electrical current through attached Ground Fault Circuit Interrupter (GFCI).

DANGER!!!!: Water and electricity pose a potentially dangerous situation. **SERVICE MUST BE SUPPLIED THROUGH A GROUND FAULT CIRCUIT INTERRUPTER (GFCI). It is recommended that a qualified electrician perform the installation of the power line equipped with a Ground Fault Circuit Interrupter (GFCI).**

OPERATING INSTRUCTIONS

Before operating your new SSAC2 DRIVE read and understand the following instructions.

TO LOWER LIFT:

1. Plug in power cord into an electrical outlet to operate the SSAC2 DRIVE electric motor.
2. Engage drive motor wheel to hand wheel by moving lever in direction of arrow until level stops.
3. Hold toggle switch in "down" position lowering hoist until boat floats freely above platform.



CAUTION: DO NOT CONTINUE TO LOWER PLATFORM AFTER BOAT FLOATS FREELY.

NOTE: TO CONSERVE POWER IT IS RECOMMENDED THAT THE DRIVE MOTOR WHEEL

continued on back page

SSAC2 Material List:

REF.#	ITEM#	DESCRIPTION	QTY.	REF.#	ITEM#	DESCRIPTION	QTY.
1		3/16" X 5/8" HALF MOON KEY	1	25	0730103	1" SLOTTED MACHINE SCREW	1
2	0140022	5/16" X 3/4" HEX BOLT	3	26	3510030	7/8" MOLDED GROMMET	1
3	0310051	3/8" X 3-1/4" ROUND U-BOLT (OPTIONAL)	2	27	3510189	BLACK PLASTIC HANDLE COVER	1
—	0310097	3/8" X 4-5/8" ROUND U-BOLT	2	28	4312000	ELECTRIC DRIVE WHEEL AND TIRE	1
4	0310106	3/8" X 1-3/4" SQUARE U-BOLT	2	29	4811338	1" BACK WASHER	1
5	1410090	1/2" X 1" HEX BOLT	1	30	5110409	AC JUMBER WIRE	2
6	0810921	#6 X 3/4" SLOTTED SHEET METAL SCREW	2	31	1410079	5/16" HEX LOCK NUT	3
7	6371401	ACDC 7 GA. CARRIAGE	1	32	0730102	#10 X 1/2" PHIL TRUSS HEAD SHEET METAL SCREW	2
8	6371001	MOTOR MOUNTING ARM	1	33	5310192	GROUNDING RING #10 SCREW	1
9	6473501	MOTOR MOUNTING BRKT WELDMENT - WHITE	1	34		1/4" X 1" STEEL SET SCREW; ALLEN	1
10	1440101	3/8" FLANGE LOCK NUT	8	35	5310208	FEMALE DISCONNECT NYLON INSULATOR	2
11	1440102	1/2" SMALL FLANGE LOCK NUT	1	36	0110020	1/4" X 3/4" HEX NUT	4
12	3820049	#9 STEEL WIRE ENGAGE LINK	1				
13	2121216	5" EXTENSION SPRING	1				
14	6370901	ENGAGE LEVER - 10 GA. WHITE	1				
15	5310020	90 VOLT ELECTRIC DC MOTOR	1				
16	5310205	3" JESSCO BOX #2000	1				
17	63711	1/2" X 2" X 8" ALUMINUM SHIM	1				
18	62252	BLUE COVER W/VELCRO - 110 VOLT DRIVE	1				
19	5310209	55046 SWITCH BOOT #81264	1				
20	6168501	HOIST MOUNTING CHANNEL	1				
21	5310212	15A 120V AC SWITCH #55046	1				
22	5310054	GFCI POWER CORD, 2' LEAD	1				
23	1430550	#10 - 32 KEP NUT	2				
24	6370801	14 GA. COVER PLATE	1				

DECALS:

—	4811388	OPERATING INSTRUCTIONS DECAL	1
—	4850178	DANGER ELECTRIC SHOCK DECAL	1
—	4810556	ENGAGE DRIVE DECAL	1
—	4810557	DOWN ARROW DECAL	1
—	4810558	UP ARROW DECAL	1
—	4850171	INSIDE PULLEY DANGER DECAL	1
—	4850169	DANGER DECAL	1
—			
—	6170201	HARDWARE BAG	1
—	6371601	AC ELECTRIC DRIVE ASSY	1

IMPORTANT: Wire selection guide.

Whenever possible, the motor should be powered from a separate branch circuit of adequate capacity to keep voltage drop to a minimum during starting and running. For longer runs, increase the wire size in accordance with the wire selection guide shown below. Never use smaller than #14 AWG (American Wire Gauge).

	110 inch/lbs. of torque			
Motor HP	25 Ft.	50 Ft.	100-150 Ft.	200 Ft.
.326	#14	#12	#10	#8

DECAL INSTALLATION

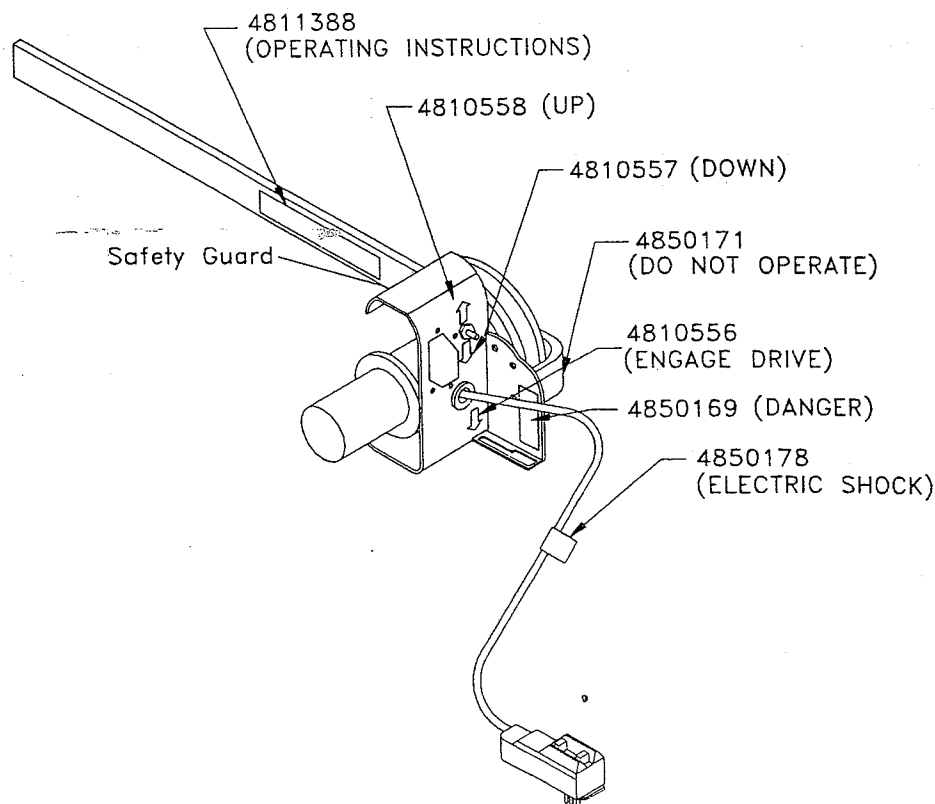

NOTE:
5310218 Replacement Rectifier

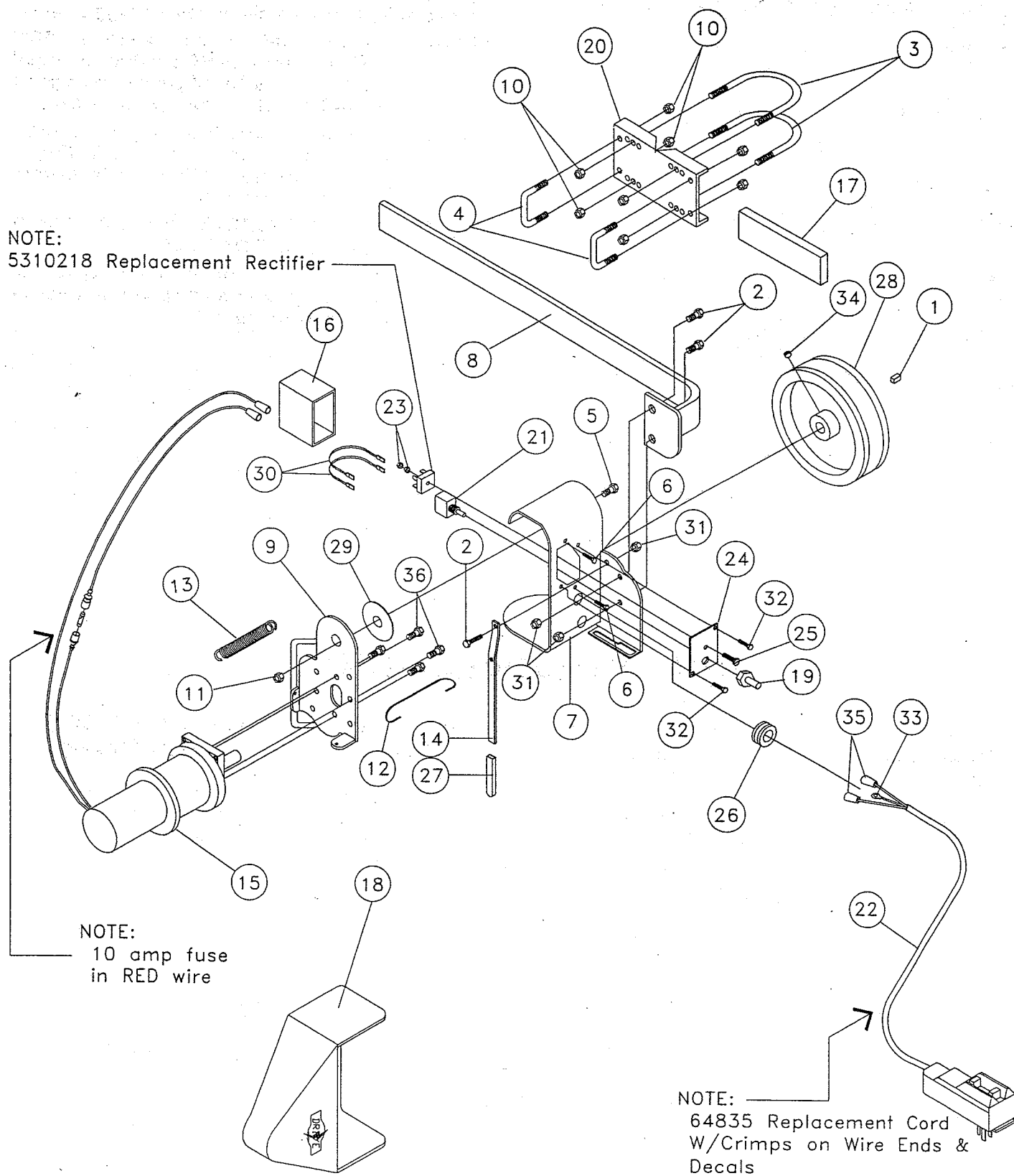

NOTE:
10 amp fuse
in RED wire

NOTE:
64835 Replacement Cord
W/Crimps on Wire Ends &
Decals

BE DISENGAGED AND THE HOIST PLATFORM BE LOWERED MANUALLY WITH THE LIFT WHEEL.

TO RAISE LIFT:

1. Using the hoist hand wheel, manually raise the hoist platform to contact bottom of the boat so it is no longer floating.

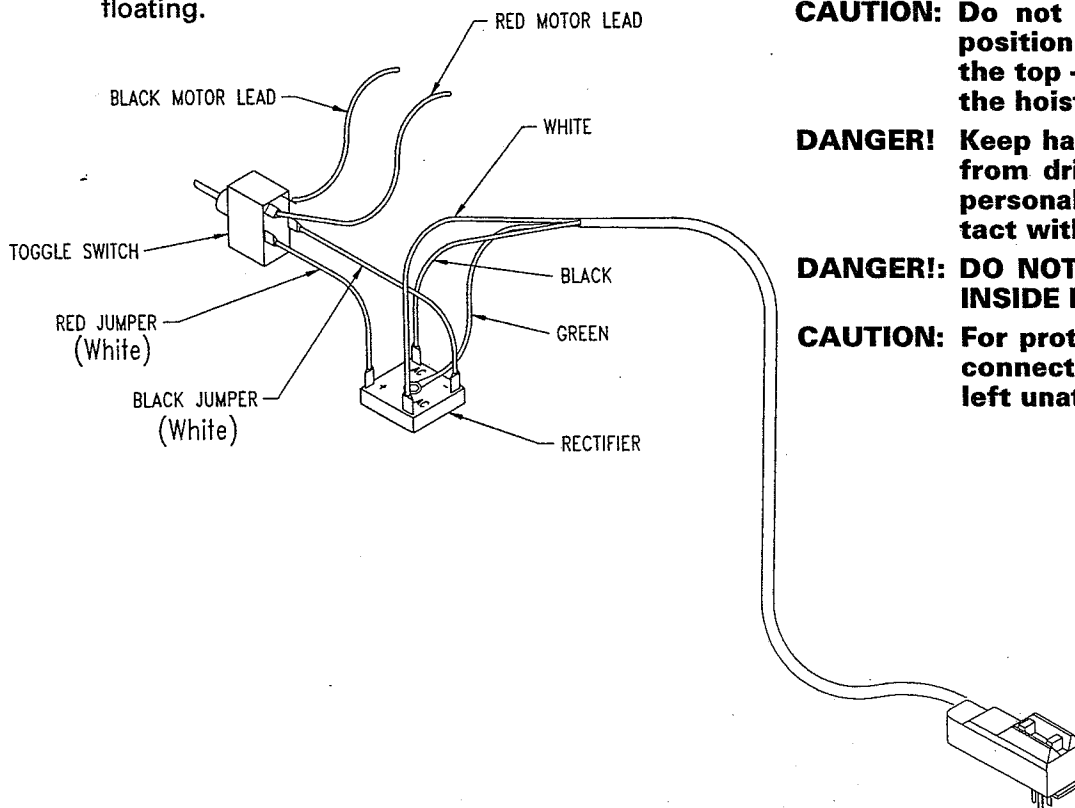

2. Connect drive motor to SSAC2 DRIVE electric outlet source.
3. Engage drive motor wheel to hand wheel by moving lever in direction of arrow until lever stops.
4. Hold toggle switch in the "up" position until the hoist platform and boat are at the desired height. To stop movement at any time, simply release toggle switch.

CAUTION: Do not hold toggle switch in "UP" position once platform has reached the top – this could cause damage to the hoist and to your drive motor!

DANGER! Keep hands and loose clothing away from drive wheel when operating -- personal injury could occur from contact with moving parts.

DANGER!: DO NOT OPERATE THIS UNIT FROM INSIDE BOAT OR HOIST!

CAUTION: For protection of others, always disconnect power source when hoist is left unattended.

SSAC2 TROUBLESHOOT

Motor Won't Run	GFI Cord Keeps Tripping	Inline Fuse Keeps Blowing	Fuse at Main FUSE BOX Keeps Tripping
Make sure all connections are in place	Power supply is not sufficient. Check manual for proper power supply cord.	Power Supply is not sufficient. Check manual for proper power supply cord.	Power supply is not sufficient. Check manual for proper power supply cord.
GFI safety cord has tripped. Push reset button.	The rectifier behind the switch is bad. Replace the rectifier using the diagram illustration in manual. Check manual for proper power supply cord. Or replace GFI switch.		
Check inline fuse. If bad replace.	Two GFI protection devices (one at the house, one supplied with motor), may create tripping.		

MIDWEST INDUSTRIES, INC.
IDA GROVE, IOWA 51445 TEL (712) 364-3365